

OWNER'S/ OPERATOR'S MANUAL

MODELS IN RBH-4600 and RBH-6500 SERIES



CAUTION

For Safe Operation
Read Rules And
Instructions Carefully.

SINO LEE INGLÉS, PIDA AYUDA
A ALGUIEN QUE SI LO LEA
PARA QUE LE TRADUZCA LAS
MEDIDAS DE SEGURIDAD.

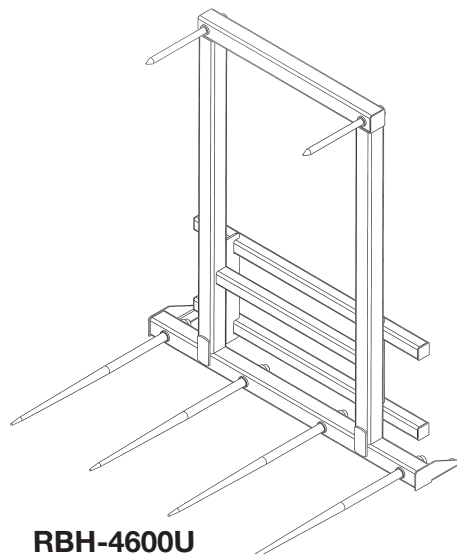

RBH-4600U

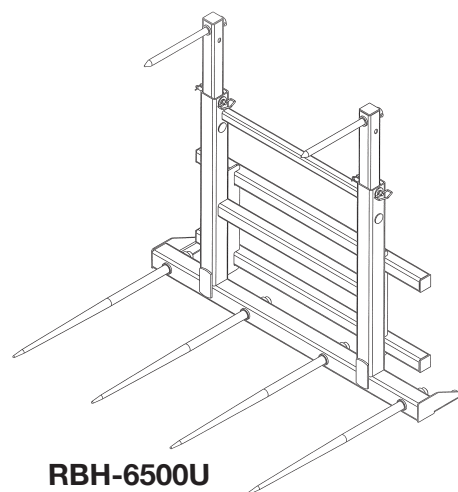

RBH-6500U

RECTANGULAR BALE HANDLER

for Tractor Front Loaders, Wheel Loaders, and Telehandlers

Safety Instructions
Tractor Preparation
Operating Instructions

Assembly & Mounting
Maintenance
Repair Parts



CAUTION



**THE FOLLOWING SAFETY PRECAUTIONS SHOULD BE THOROUGHLY UNDERSTOOD
BEFORE ATTEMPTING TO BEGIN ASSEMBLING THIS MACHINE**

1. Select an area for assembly that is clean and free of any debris which might cause persons working on the assembly to trip.
2. Do not lift heavy parts or assemblies. Use crane, jack, tackle, fork trucks or other mechanical devices.
3. Preview the assembly instructions in your operator's manual before proceeding further.
4. If the assembly instructions call for parts or assemblies to be blocked up, use only blocking material that is in good condition and is capable of handling the weight of the assembly to be blocked. Also insure that the blocking material is on a clean, dry surface.
5. Never put hands, or any part of body, under blocked up assemblies if at all possible.
6. After completing assembly, thoroughly inspect the machine to be sure that all nuts, bolts, hydraulic fittings or any other fastened assemblies have been thoroughly tightened.
7. Before operating the machine, thoroughly read the operation section of your operator's manual.
8. Before operating, read the maintenance section of your operator's manual to be sure that any parts requiring lubrication, such as gearboxes, are full, to avoid any possible damage.
9. **Before operating equipment - If you have any questions regarding the proper assembly or operation, contact your dealer or representative.**

TABLE OF CONTENTS

WARRANTY.....	2
SAFETY INFORMATION.....	3-12
SAFETY SIGNS	13
PREPARATION INSTRUCTIONS.....	14-15
OPERATING INSTRUCTIONS.....	16-19
OWNER MAINTENANCE & LUBRICATION.....	20
TROUBLE-SHOOTING.....	21
NOTES.....	22
PARTS LIST	23-26
MOUNTING OPTIONS	27-28

SINO LEEINGLES, PIDA AYUDA
A AIGUIEN QUE SI LO LEA PARA
QUE LE TRADUZCA LAS MEDI-
DAS DE SEGURIDAD.

STATEMENT OF POLICY

It is the policy of Worksaver, Inc. to improve its products where it is possible and practical to do so. Worksaver, Inc. reserves the right to make changes or improvements in design and construction at any time, without incurring the obligation to make these changes on previously manufactured units.

TO THE OWNER:

Read this manual before using your Rectangular Bale Handler. This manual is provided to give you the necessary operating and maintenance instructions for keeping your Rectangular Bale Handler in top operating condition. Please read this manual thoroughly. Understand what each control is for and how to use it. Observe all safety signs on the machine and noted throughout the manual for safe operation of implement. Keep this manual handy for ready reference.

Like all mechanical products, it will require cleaning and upkeep. Lubricate the Rectangular Bale Handler as specified.

Use only genuine Worksaver, Inc. service parts. Substitute parts will void the warranty and may not meet standards required for safe and satisfactory operation. Record the model and serial number of your Rectangular Bale Handler here:

Model: _____ Serial Number: _____

RETAIL CUSTOMER'S RESPONSIBILITY

It is the Retail Customer and/or Operator's responsibility to read the Operator's Manual, to operate, lubricate, maintain, and store the product in accordance with all instructions and safety procedures. Failure of the operator to read the Operator's Manual is a misuse of this equipment.

It is the Retail Customer and/or Operator's responsibility to inspect the product and to have any part(s) repaired or replaced when continued operation would cause damage or excessive wear to other parts or cause a safety hazard.

It is the Retail Customer's responsibility to deliver the product to the authorized Worksaver Dealer, from whom he purchased it, for service or replacement of defective parts which are covered by warranty. Repairs to be submitted for warranty consideration must be made within forty-five (45) days of failure.

It is the Retail Customer's responsibility for any cost incurred by the Dealer for traveling to or hauling of the product for the purpose of performing a warranty obligation or inspection.

LIMITED WARRANTY

Worksaver warrants to the original purchaser of any new Rectangular Bale Handler (any model of the RBH-4600 Series or RBH-6500 Series), that the equipment be free from defects in material and workmanship for a period of one (1) year for non-commercial, state, and municipalities. Use ninety (90) days for commercial use from date of retail sale.

Replacement or repair parts installed in the equipment covered by this warranty are warranted for sixty (60) days from the date of purchase of such part or to the expiration of the applicable new equipment warranty period, whichever occurs later.

Such parts shall be provided at no cost to the user during regular working hours. Worksaver reserves the right to inspect any equipment or parts which are claimed to have been defective in material or workmanship.

DISCLAIMER OF IMPLIED WARRANTIES & CONSEQUENTIAL DAMAGES

Worksaver's obligation under this warranty, to the extent allowed by law, is in lieu of all warranties, implied or expressed, including implied warranties of merchantability and fitness for a particular purpose and any liability for incidental and consequential damages with respect to the sale or use of the items warranted. Such incidental and consequential damages shall include but not be limited to: transportation charges other than normal freight charges; cost of installation other than cost approved by Worksaver; duty; taxes; charges for normal service or adjustments; loss of crops or any other loss of income; rental of substitute equipment, expenses due to loss, damage, detention or delay in the delivery of equipment or parts resulting from acts beyond the control of Worksaver.

THIS WARRANTY SHALL NOT APPLY:

1. To vendor items which carry their own warranties, such as hydraulic cylinders, tires, and tubes.
2. If the unit has been subjected to misapplication, abuse, misuse, negligence, fire or other accident.
3. If parts not made or supplied by Worksaver have been used in connection with the unit, if, in sole judgement of Worksaver such use affects its performance, stability, or reliability.
4. If the unit has been altered or repaired outside of an authorized Worksaver dealership in a manner which, in the sole judgement of Worksaver affects its performance, stability, or reliability.
5. To normal maintenance service and normal replacement items such as gearbox lubricant, hydraulic fluid, worn blades, or to normal deterioration of such things as belts and exterior finish, due to use or exposure.
6. To expendable or wear items such as teeth, forged tines, plastic bearings and other items that in the company's sole judgement is a wear item.

NO EMPLOYEE OR REPRESENTATIVE OF WORKSAVER IS AUTHORIZED TO CHANGE THIS WARRANTY IN ANY WAY OR GRANT ANY OTHER WARRANTY UNLESS SUCH CHANGE IS MADE IN WRITING AND SIGNED BY WORKSAVER'S SERVICE MANAGER, POST OFFICE BOX 100, LITCHFIELD, ILLINOIS 62056-0100.

To the Owner/Operator/Dealer

All implements with moving parts are potentially hazardous. There is no substitute for a cautious, safe-minded operator who recognizes the potential hazards and follows reasonable safety practices. The manufacturer has designed this implement to be used with all its safety equipment properly attached to minimize the chance of accidents.

BEFORE YOU START!!

Read the safety messages on the implement and shown in your manual.

Observe the safety rules of safety and common sense!



THIS SYMBOL MEANS

- **ATTENTION!**
- **BECOME ALERT!**
- **YOUR SAFETY IS INVOLVED!**

THIS SAFETY ALERT SYMBOL IDENTIFIES IMPORTANT SAFETY WARNING MESSAGES. CAREFULLY READ EACH WARNING MESSAGE THAT FOLLOWS. FAILURE TO UNDERSTAND AND OBEY A SAFETY WARNING, OR RECOGNIZE A SAFETY HAZARD, COULD RESULT IN AN INJURY OR DEATH TO YOU OR OTHERS AROUND YOU. THE OPERATOR IS ULTIMATELY RESPONSIBLE FOR THE SAFETY OF HIMSELF, AS WELL AS OTHERS, IN THE OPERATING AREA OF THE POWER UNIT AND ATTACHED EQUIPMENT.

UNDERSTAND SIGNAL WORDS

Note the use of signal words **DANGER**, **WARNING** and **CAUTION** with the safety messages. The appropriate signal word for each has been selected using the following guidelines:

DANGER: Indicates an imminently hazardous situation that, if not avoided, will result in death or serious injury. This signal word is to be limited to the most extreme situations typically for machine components which, for functional purposes, cannot be guarded.

WARNING: Indicates a potentially hazardous situation that, if not avoided, could result in death or serious injury, and includes hazards that are exposed when guards are removed. It may also be used to alert against unsafe practices.

CAUTION: Indicates a potentially hazardous situation that, if not avoided, may result in minor or moderate injury. It may also be used to alert against unsafe practices.

If you have any questions not answered in this manual or require additional copies or the manual is damaged, please contact your dealer or the manufacturer directly.

IMPORTANT SAFETY INFORMATION!

Working with unfamiliar equipment can lead to careless injuries. Read this manual, and the manual for your tractor or telehandler, before assembly or operating, to acquaint yourself with the machines. It is the implement owner's responsibility, if this machine is used by any person other than yourself, is loaned or rented, to make certain that the operator, prior to operating:

1. Reads and understands the operator's manuals.
2. Is instructed in safe and proper use.



The use of this equipment is subject to certain hazards which cannot be protected against by mechanical means or product design. All operators of this equipment must read and understand this entire manual, paying particular attention to safety and operating instructions, prior to using. If there is something in this manual you do not understand, ask your supervisor, or your dealer, to explain it to you.

SAFETY INSTRUCTIONS (continued)



EQUIPMENT SAFETY GUIDELINES

NOTICE: TELEHANDLER OSHA RULE -

OSHA Rule 1910.178 (I) requires operators of Class 7 Forklifts - - more commonly known as Telehandlers - - to pass an operators safety training class before operating any unit.

The class can be held on site, with a certified instructor. OSHA inspectors can stop at any Construction or Work Site to determine if the Operator has had proper training. The OSHA Rule clearly states that it is the responsibility of the operators employer to make sure that all operators are properly trained.



Safety of the operator is one of the main concerns in designing and developing a new piece of equipment. Designers and manufacturers build in as many safety features as possible. However, every year many accidents occur which could have been avoided by a few seconds of thought and a more careful approach to handling equipment. You, the operator, can avoid many accidents by observing the following precautions in this section. To avoid personal injury, study the following precautions and insist those working with you, or for you, follow them.



In order to provide a better view, certain photographs or illustrations in this manual may show an assembly with a safety shield removed. However, equipment should never be operated in this condition. Keep all shields in place. If shield removal becomes necessary for repairs, replace the shield prior to use.



Replace any CAUTION, WARNING, DANGER or instruction safety sign that is not readable or is missing. Location of such safety signs is indicated in this booklet.



Never use alcoholic beverages or drugs which can hinder alertness or coordination while operating this equipment. Consult your doctor about operating this machine while taking prescription medications.



Review the safety instructions with all users annually.



This equipment is dangerous to children and persons unfamiliar with its operation. The operator should be a responsible adult familiar with farm machinery and trained in this equipment's operations. **Do not allow persons to operate or assemble this unit until they have read this manual and have developed a thorough understanding of the safety precautions and of how it works.**



To prevent injury or death, power unit must be equipped with ROPS or ROPS cab and seat belt. Keep seat belt securely fastened. Falling off power unit can result in death from being run over or crushed. Keep foldable ROPS system in "locked up" position at all times.



Never exceed the limits of a piece of machinery. If its ability to do a job, or to do so safely, is in question - **DON'T TRY IT.**



Do not modify the equipment in any way. Unauthorized modification may impair the function and/or safety and could affect the life of the equipment.

SAFETY INSTRUCTIONS (continued)



SAFETY TRAINING

NOTICE: TELEHANDLER OSHA RULE -

OSHA Rule 1910.178 (I) requires operators of Class 7 Forklifts - - more commonly known as Telehandlers - - to pass an operators safety training class before operating any unit.

The class can be held on site, with a certified instructor. OSHA inspectors can stop at any Construction or Work Site to determine if the Operator has had proper training. The OSHA Rule clearly states that it is the responsibility of the operators employer to make sure that all operators are properly trained.



In addition to the design and configuration of this implement, including Safety Signs and Safety Equipment, hazard control and accident prevention are dependent upon the awareness, concern, prudence, and proper training of personnel involved in the operation, transport, maintenance, and storage of the machine. Refer also to Safety Messages and Operation Instructions in each of the appropriate sections of the Tractor, Telehandler, Wheel Loader, Skid Steer, and Implement Manuals. Pay close attention to the Safety Signs affixed to the Tractor, Telehandler, Wheel Loader, Skid Steer, and the Implement.



Safety is a primary concern in the design and manufacture of our products. Unfortunately, our efforts to provide safe equipment can be wiped out by a single careless act of an operator.



In addition to the design and configuration of equipment, hazard control and accident prevention are dependent upon the awareness, concern, prudence and proper training of personnel involved in the operation, transport, maintenance and storage of equipment.



Working with unfamiliar equipment can lead to careless injuries. Read this manual, and the manual for your power unit, before assembly or operating, to acquaint yourself with the machines. It is the equipment owner's responsibility, if this machine is used by any person other than yourself, is loaned or rented, to make certain that the operator, prior to operating:

1. Reads and understands the operator's manuals.
2. Is instructed in safe and proper use.



Know your controls and how to stop tractor, engine, and loader quickly in an emergency. Read this manual and the one provided with your power unit.



Train all new personnel and review instructions frequently with existing workers. A person who has not read and understood all operating and safety instructions is not qualified to operate the machine. An untrained operator exposes himself and bystanders to possible serious injury or death.



Do not allow children to operate this machine.



Make sure operator of Telehandler understands Load Charts in Telehandler manual.

SAFETY INSTRUCTIONS (continued)



OPERATIONAL SAFETY



The use of this equipment is subject to certain hazards which cannot be protected against by mechanical means or product design. All operators of this equipment must read and understand this entire manual, paying particular attention to safety and operating instructions, prior to using. If there is something in this manual you do not understand, ask your supervisor, or your dealer, to explain it to you.



Most accidents occur because of neglect or carelessness. Keep all helpers and bystanders fifty feet (50') from an operating power unit and attached equipment. Only properly trained people should operate this machine. It is recommended the power unit be equipped with a Rollover Protection System (ROPS) and a seat belt that is used. Always stop the power unit, set brakes, shut off the engine, remove the key, and lower loader to the ground before dismounting power unit. Never leave equipment unattended with the power unit running.



Please remember it is important that you read and heed the safety signs on the front loader attachment and loader, and the safety rules set forth. Clean or replace all safety signs if they cannot be clearly read and understood. They are there for your safety as well as the safety of others. The safe use of this machine is strictly up to you, the operator.



Be sure power unit is in good condition. Read all the safety precautions and make sure all operators are familiar with the safety rules of operation.



Know your controls and how to stop power unit and engine quickly in an emergency. READ THIS MANUAL AND THE ONE PROVIDED WITH YOUR TRACTOR AND LOADER, TELEHANDLER, SKID STEER, OR WHEEL LOADER.



When the use of hand tools is required to perform any part of assembly, installation, adjustment, maintaining, repairing, removal, or moving the implement, be sure the tools used are designed and recommended by the tool manufacturer for that specific task.



Personal protection equipment including safety glasses, safety shoes, and gloves are recommended during assembly, installation, operation, adjustment, maintaining, repairing, removal, or moving the attachment.



Always use two people to handle heavy, unwieldy components during assembly, installation, removal, or moving the loader attachment.



Never place any part of your body where it would be in danger if movement should occur during assembly, installation, operation, maintaining, repairing, removal, or moving the implement.



The use of any loader attachment is NOT recommended on tractor with a tricycle wheel arrangement. Tricycle type tractors are unstable for front loader use.



A heavy load can cause instability in driving a power unit. Make sure the front or rear of the power unit is properly counter-balanced with weights. Always drive slowly - especially around turns. An unstable power unit could steer badly and possibly tip over, causing injury or death.



Do not allow others to ride on the power unit with an operator. Riders are subject to injury such as being struck by foreign objects or being thrown off. Riders obstruct the operator's view resulting in unsafe operation. **Never allow anyone to ride on the implement.**

SAFETY INSTRUCTIONS (continued)



OPERATIONAL SAFETY (continued)



Before you operate any equipment, check over all pins, bolts and connections to be sure all are securely in place. Replace any damaged or worn parts immediately.



Do not work under a raised loader unless it is securely blocked or held in position. Do not depend on the power unit hydraulic system to hold the implement in place.



Operate the loader controls smoothly, avoiding jerky operation. Stop loader gradually when lowering or lifting loads.



Beware of low electrical wires when loader is raised. Serious injury or death can result if contact is made.



When handling bales on a slope, always approach the bale with the power unit facing uphill.



Never use the tractor/loader or telehandler to stop a rolling bale.



Only use a power unit equipped with a ROPS cab or rollover protective structure.



When stacking bales, ALWAYS MAKE SURE BALES ARE PLACED SO THE STACK IS STABLE.



Keep all bystanders at a safe distance. REMEMBER FALLING BALES CAN ROLL OR TUMBLE.



Do not handle bales where total weight exceeds the weight limitations of the loader.



Carry the bales slowly and as low as practical to the ground.



For operator safety, always keep load in front of power unit hood. NEVER position load back over operator. ALWAYS BE CAREFUL!



Always load rear of tractor first and unload last when using a front loader.



Beware of lift clearance when raising loader to maximum height.



Keep alert and watch the rear as well as the front when working with the loader.

SAFETY INSTRUCTIONS (continued)



OPERATIONAL SAFETY (continued)



When maneuvering close to buildings or passing through narrow areas, be sure to allow sufficient clearance for the power unit, loader, and bales. Drive slowly.



Operate power unit from operator's seat only. Remain at controls until operating cycle is complete.



Use extreme care when working on inclines and hillsides.



Avoid steep slopes or unstable surfaces. When operating on a slope keep the load low and proceed with extreme caution. DO NOT drive ACROSS a steep slope, drive straight up and down. With a loaded attachment - face the attachment and load uphill. With an empty attachment - face the attachment downhill.



Do not lower the boom, if it is retracted and the attachment is rotated in the downward position. Spikes or tines on the attachment may contact and damage the front wheels of the operating machine.



Never stack loads on uneven ground. Loads stacked on uneven ground can topple.



Electrocution can result from contacting or approaching underground or overhead power cables. Check overhead clearances; know your margin of safety. If possible, have power lines disconnected, if not possible, request a signal person for guidance.



Do not lift or carry anyone on loader or in bucket or on attachment. Do not use loader for a work platform.



ALWAYS lower loader to the ground or block securely before performing any maintenance work.



Never allow anyone to walk or work under a raised loader.



Be sure that people, livestock, or pets are not standing near the machine while operating.



Do not operate close to ditches, creeks or holes. Slow down when operating over rough ground.



Avoid excessive speed during operation. Use extreme care when working on inclines and hillsides.



Always keep power unit on solid footing when operating loader.



Observe Safety Recommendations in loader instruction manual, understand Telehandler Load Charts.



Inspect the entire machine periodically as indicated in the Maintenance Section of this manual. Look for loose fasteners, worn or broken parts, pinched hydraulic hoses, and leaky or loose fittings. Make sure all pins have cotter pins and washers. Serious injury may occur from not maintaining this machine in good working order.

SAFETY INSTRUCTIONS (continued)



TRANSPORT SAFETY



Comply with state and local laws governing highway safety and movement of farm machinery on public roads.



The use of flashing amber lights is acceptable in most localities. However, some localities prohibit their use. Local laws should be checked for all highway lighting and marking requirements.



When driving equipment on the road or highway under 20 mph (32 kph) at night or during the day, use flashing amber warning lights and a slow moving vehicle (SMV) identification emblem.



Always be sure the implement is in the proper position for transport.



Reduce speed when transporting mounted implements to avoid bouncing and momentary loss of steering control.



Plan your route to avoid heavy traffic.



Do not travel on the road with bales on the Bale Handler. The power unit may tip if the brakes are applied quickly or if a rapid turn is made. Bales on attachment can/will obstruct forward vision.



Do not drink and drive!



Watch for traffic when operating near or crossing roadways.



Turn curves or go up or down hills only at a low speed and at a gradual steering angle. Make certain that at least 20% of the tractor's weight is on the front wheels to maintain safe steerage. Slow down on rough or uneven surfaces, and loose gravel.



Use extreme care and maintain minimum ground speed when transporting on hillside, over rough ground and when operating close to ditches or fences. Be careful when turning sharp corners.



Never allow riders on either power unit or implement. Falling off can kill.



Be a safe and courteous driver. Always yield to oncoming traffic in all situations, including narrow bridges, intersections, etc.



Do not exceed 20 mph (32 kph). Reduce speed on rough roads and surfaces.

SAFETY INSTRUCTIONS (continued)



MAINTENANCE SAFETY



Good maintenance is your responsibility. Poor maintenance is an invitation to trouble.



Follow good shop practices.

- Keep service area clean and dry.
- Be sure electrical outlets and tools are properly grounded.
- Use adequate light for the job at hand.



Make sure there is plenty of ventilation. Never operate the engine of the vehicle in a closed building. The exhaust fumes may cause asphyxiation.



Before working on this machine, drive to a level area, disengage the PTO, lower equipment or loader (or if working underneath, raise and block securely), shut off the engine, relieve all hydraulic pressure, set the brakes, and remove the ignition keys.



Be certain all moving parts on attachments have come to a complete stop before attempting to perform maintenance.



Never work under equipment unless it is blocked securely. Never depend on hydraulic system to keep implement in raised position.



Keep all persons away from operator control area while performing adjustments, service, or maintenance.



Always use personal protection devices such as eye, hand and hearing protectors, when performing any service or maintenance.



Periodically tighten all bolts, nuts and screws and check that all cotter pins are properly installed to ensure unit is in a safe condition.



When completing a maintenance or service function, make sure all safety shields and devices are installed before placing unit in service.



Openings in the skin and minor cuts are susceptible to infection from hydraulic fluid. If injured by escaping hydraulic fluid, see a doctor at once. Gangrene and death can result. Without immediate medical treatment, serious infection and reactions can occur.

SAFETY INSTRUCTIONS (continued)



MAINTENANCE SAFETY (continued)



After servicing, be sure all tools, parts and service equipment are removed.



Check to ensure all safety signs are installed and in good condition. (See safety sign section for location drawing.)



Do not allow grease or oil to build up on any deck or platform.



Never replace hex bolts with less than grade five bolts unless otherwise specified, i.e. shear bolts. Refer to bolt torque chart for head identification marking.



Where replacement parts are necessary for periodic maintenance and servicing, genuine factory replacement parts must be used to restore your equipment to original specifications. The manufacturer will not claim responsibility for use of unapproved parts and/or accessories and other damages as a result of their use.



If equipment has been altered in any way from original design, the manufacturer does not accept any liability for injury or warranty.



A fire extinguisher and first aid kit should be kept readily accessible while performing maintenance on this equipment.



STORAGE SAFETY



Following operation or when unhooking, stop the power unit, set the brakes, shut off the engine, relieve all hydraulic pressure and remove the ignition keys.



Store the unit in an area away from human activity.



Do not park equipment where it will be exposed to livestock for long periods of time. Damage and livestock injury could result.



Do not permit children to play on or around the stored unit.



Make sure all parked machines are on a hard, level surface and engage all safety devices.



If blocking is used, make sure it is solid and secure before leaving area.

SAFETY INSTRUCTIONS (continued)



SAFETY SIGNS



Keep safety signs clean and legible at all times.



Replace safety signs that are missing or have become illegible.



Replaced parts that displayed a safety sign should also display the current sign.



Safety signs are available from your Distributor or Dealer Parts Department or the factory.

How to Install Safety Signs:



Be sure that the installation area is clean and dry.



Be sure temperature is above 50° F (10° C).



Decide on the exact position before you remove the backing paper.



Remove the smallest portion of the split backing paper.



Align the sign over the specified area and carefully press the small portion with the exposed sticky backing in place.



Slowly peel back the remaining paper and carefully smooth the remaining portion of the sign in place.



Small air pockets can be pierced with a pin and smoothed out using the piece of sign backing paper.



STARTING AND STOPPING SAFETY



Be certain the power unit is in neutral or park position before starting engine.



Always shut off power unit and shift to “Park” or set brakes when leaving power unit. Always lower bucket or attachment to ground, relieve all hydraulic pressure. Remove key when leaving power unit unattended. Park in level area.



Before operating equipment: if you have any questions regarding the proper assembly or operation, contact your dealer or representative.

SAFETY SIGNS



**Used on RBH-6500
Series Only**



REMEMBER: If Safety Signs have been damaged, removed, become illegible or part replaced without Signs, new Safety Signs must be applied. New Safety Signs are available from your authorized distributor or factory.



WARNING

- Read and follow owner's manual before installing, operating, or performing maintenance on this attachment. Observe safety recommendations in manual.
- Do not exceed capacity weight limit of attachment or power unit.
- Attachment should be used with proper counterweights. When handling loads of both ends of the power unit, load rear first and unload last.
- Set wheels wide for increased stability.
- Never take load to extreme heights on steep inclines.
- When handling large bales, keep load as low as practical to maximize power unit stability.
- Be sure bolt-in stabilizer spikes are installed. Stabilizer spikes prevent uncontrolled bale movement.
- When handling large bales, make sure visibility is not obstructed forward or for safety devices on rear.
- Do not stand or work under raised attachment.
- Stop engine, lower arms, relieve all hydraulic pressure, and lock brakes before leaving operator's seat.
- Failure to follow the above precautions can result in serious injury or death.

101560

INSTRUCTIONS

TRACTOR, WHEEL LOADER, AND TELEHANDLER REQUIREMENTS AND PREPARATION

The Rectangular Bale Handler Models are designed to handle and stack large size rectangular bales. They can handle two (2) 4' X 4' X 8' bales or three (3) 3' X 3' X 8' bales.

RBH models in the RBH-4600 Series have an 80 inch high welded frame. There are currently ten (10) models with a variety of attaching couplers. See pages 27 and 28 of this manual.

The models in the RBH-6500 Series have a variable height frame from 50.25 inches to 84.25 inches. The two adjustable bale backstops may also be set at a 64 inch height if desired.

The RBH-6500 Series Rectangular Bale Handlers with the adjustable height bale backstops allow use in hay barns with a lower ceiling height and in loading trucks.

The ten (10) models in the RBH-6500 Series also offer the variety of attaching couplers. See pages 27 and 28.

All of the Rectangular Bale Handlers in both Series have two bolt-in stabilizer spears at the top to steady the top bale.

All Rectangular Bale Handler models have four (4) forged tapered spears across the lower tube frame with a usable length of 42".

Models RBH-4600U and RBH-6500U are recommended for Farm Tractors with a PTO horsepower rating of at least 85 hp and equipped with a front loader rated at 4,000 lb. or more. Optional brackets are available to fit most pin on or quick coupler front end loaders.

Wheel Loaders and Telehandler units need to have sufficient lift capacity to handle the expected load and the weight of the Bale Handler.

Weigh some of the bales to be handled so you have a more accurate total weight of the Bale Handler and the bales.

NOTE: The Bale Handler is only recommended for power units equipped with a rollover protective structure (ROPS) or (ROPS) cab.

Be sure tires and rims are in good condition. Inflate tires to the proper recommended air pressure.

Power unit must be equipped with ROPS or ROPS CAB and seat belt. Keep seat belt securely fastened. Falling off power unit can result in death from being run over or crushed. Keep foldable ROPS system in "locked up" position at all times.

Check the power unit's hydraulic system. Be sure the hydraulic oil and filter have been serviced according to manufacturer's recommendations. Refer to your tractor or loader operator's manual or dealer for any adjustments necessary to put the hydraulic system in good working order.



CAUTION!

Be sure your tractor and loader, wheel loader, or telehandler is in good condition. Read all the safety precautions and make sure all equipment operators are familiar with the safety rules of operation.

The operator is responsible for the safe operation of this equipment. The operator must be properly trained. Operators should be familiar with the power unit, loader and loader attachment, and all safety practices before starting operation. Read the safety rules and safety signs on pages 3-13.



WARNING!

A heavy load can cause instability in driving a power unit. Make sure the rear of the tractor is properly counterbalanced with weights. Always drive slowly - especially around turns. An unstable power unit could steer badly and possibly tip over, causing injury or death.



CAUTION!

Check Telehandler Operator's Manual Load Charts for your model. Keep loads within the safe limits in the Load Charts.

INSTRUCTIONS (continued)

ASSEMBLY - GENERAL

This unit is shipped almost completely assembled.

Refer to the “exploded views” on pages 23-26 of this manual.

Carefully follow instructions for final assembly.

Before attempting assembly check the following items. Having all the needed parts and equipment readily at hand will speed up your assembly task and will make the job as safe possible.

- Check for fasteners and pins that were shipped with the Rectangular Bale Handler.
- Have a fork lift or loader along with chains and safety stands that are sized for the job ready for the assembly task.
- Have a minimum of 2 people at hand during assembly.
- Check to see that all fasteners are tightened.

It is suggested that you mount the RBH frame on your power unit before you install the spears.

ASSEMBLY - TRACTOR LOADERS

Remove the bucket from your front end loader. Check your loader to make sure it is in good working order. Check all frame mounting bolts to make sure they are tight.

Assemble the two lift brackets (Ref. #10) on the main frame (Ref. #1) with the 5/8" X 3" I.D. U-bolts. Leave the U-bolts loose.

NOTE: The lift channel brackets are supplied with 1" diameter pins to fit your loader. If your loader requires 1 1/8" pins or 1 1/4" dia. pins, ask your dealer to order the needed brackets and pins. Be sure to indicate if two or four pins are required. The brackets and pins can be shipped via UPS.

NOTE: The Ford Model 7109, 7209, 7210 and 7410 Pin Type Loaders require special mounting bracket instead of the standard lift channels supplied. Order #830330 for this application.

Connect the bracket assembly to the loader arms using the bottom hole in the channel and attach the upper control cylinder to the top hole in the lift channels. Center the main frame (side to side) with your loader arms and tighten the four (4) 5/8" X 3" U-bolts.

The lower hole positions in the lift channels can be used to obtain more angle movement. However, if the frame becomes too parallel with the loader lift arms, the loader may not have enough power (mechanical advantage) to bring the frame back.

NOTE: Generally, it is not recommended to have the tilt cylinders located any closer than 10-12 inches to the main loader lift arms. **Check the spacing of mounting pins on your loader bucket and use this as a guide.**

If tilt cylinders are located too close to the loader arms, they may go “over center” when fully extended. If this happens, damage may occur to the cylinders and/or mounting brackets.

NOTE: Loaders with only one hydraulic cylinder in the center of the loader to tilt the bucket or attachment may NOT be used with the Rectangular Bale Handler.

If your tractor loader has a bucket Quick Attach feature, check with your dealer on the availability of adapter brackets for your brand and model loader.

ASSEMBLY - TELEHANDLER AND WHEEL LOADERS

Remove the bucket from your telehandler or wheel loader unit and connect the quick-attach coupler that is welded on the Bale Handler frame.

The Bale Handler Telehandler and wheel loader models have a quick-attach bracket welded on the frame. No other special brackets are required. Make sure latch pins engage to lock the frame in place.



CAUTION!

To help prevent personal injury, stand clear of frame and loader. Keep feet away from underside of main frame.

INSTRUCTIONS (continued)

ASSEMBLY (continued)

After mounting and locking the Rectangular Bale frame on the power unit, raise the RBH frame about 4" - 6" off the ground. Place wood blocks under the bottom 4" X 4" tube for safety.

Install the four (4) 47" long spears into the sockets that are welded in the 4" X 4" tube. Position each spear to align the cross hole in the spear with the cross hole in the socket.

Install a 1/2" X 3.0" bolt in each cross hole. Install the lock washer and nut on each bolt. Tighten bolts.

Now install the two stabilizer spears at the top of the frame. Tighten those bolts. (The stabilizer spears on models in the RBH-6500 Series are in the top of the adjustable backstops.)

PRE-OPERATION CHECKLIST

(OWNER/OPERATOR RESPONSIBILITY)

- _____ Review and follow safety rules and safety signs on pages 3 through 13.
- _____ Check that Bale Handler is properly and securely attached to the power unit.
- _____ Check that all hardware is properly installed.
- _____ Check that no one enters the area of machine operation. Always work at a safe distance from roads, built-up areas, or populated places.
- _____ Know your controls and how to stop power unit, engine and PTO quickly in an emergency. **READ THIS MANUAL AND THE ONE PROVIDED WITH YOUR POWER UNIT.**
- _____ To avoid accident or injury, do not allow anyone to operate this equipment without proper instructions. Any person who operates this equipment must be instructed in and be capable of the safe operation of the tractor, telehandler, attachment and all controls.
- _____ Be sure the tractor is properly counter-balanced with weights before attempting to lift any load with the Bale Handler Attachment.
- _____ When working on side hills, **DO NOT RAISE LOADER TOO HIGH.** Keep an eye on terrain changes. Keep load low.

SAFETY INSTRUCTIONS

Observe all instruction and safety decals on the Bale Handler. These safety signs are shown for reference. Read them carefully before using the Bale Handler. Replace any decals that may be faded or damaged.

Make sure all operators have read the Owner's/Operator's Manual and are familiar with the instructions and the safety rules or operation.



OPERATE LOADER SAFELY

- Improper use of loader can cause serious injury or death.
- Become familiar with controls.
- Be sure anyone operating the loader is aware of safe operation and potential hazards. Read and observe safety recommendations in loader manual.
- Operate loader from operator's seat only. Remain at controls until operating cycle is complete.
- Stop loader gradually when lowering or lifting loads.
- Use particular care when working on inclines and hillsides.
- Avoid holes, ditches, and obstructions which may cause tractor/loader to tip.
- Allow for additional length of loader on tractor while turning.
- Never allow anyone to walk or work under a raised loader.
- Be sure that people, livestock, or pets are not standing near the machine while operating.
- Do not handle loads that exceed the weight limitations of the loader or power unit.
- Carry the loads slowly and as low as possible to the ground.
- Operate the loader hydraulic controls smoothly, avoiding jerky operation.
- When handling material on a slope, always approach the material with the unit facing uphill.
- Only use a tractor or power unit equipped with a ROPS cab or roll-over protective structure.
- Travel slowly over rough ground or when making turns.
- Lower bucket or attachment to ground when loader is unattended.

OPERATING INSTRUCTIONS (continued)

OPERATION (continued)

Only qualified people familiar with this manual should operate this machine. Operator should wear hard hat, safety glasses, and safety shoes. It is required that the power unit be equipped with Roll-Over Protective System (ROPS) and a seat belt be used. (A four post ROPS or a ROPS equipped with a heavy duty sun shade works best.) Check for ditches, stumps, holes, or other obstacles that could upset power unit or damage the bale handler. Always turn off engine, set parking brake, lower loader to ground and relieve hydraulic pressure before dismounting power unit.

Safety is a primary concern in the design and manufacture of our products. Unfortunately, our efforts to provide safe equipment can be wiped out by a single careless act of an operator.

It has been said, "The best safety device is an informed, careful operator". We ask you to be that kind of an operator.

The designed and tested safety of this machine depends on it being operated within the limitations as explained in this manual. Be familiar with and follow all safety rules in the manual, on the bale handler and on the tractor, telehandler, skid steer, or wheel loader.

The safe operation of this machine is the responsibility of the owner/operator. The operator should be familiar with the bale handler and power unit and all safety practices before starting operation. Read the safety rules on pages 3-13.

Before using the Bale Handler, check all bolts to be sure they are properly installed.

After the Bale Handler has been installed on the loader, raise it up and down and tilt it up and down, check for any binding that may occur between the loader and loader brackets. If any binding is occurring, it must be remedied before damage occurs.



WARNING!

Damage to equipment, or personal injury could occur if Bale Handler is not properly attached to the loader. The Bale Handler could become detached from the loader and fall.

HANDLING BALES

Operation of the Bale Handler is relatively simple, however, experience is very important in making a tight, straight stack. The Bale Handler, along with the operator skill, will allow you to move bales without manual labor.

Using the bucket tilt cylinders, adjust the angle of the spear(s) so they are parallel with the center of the hay bale. Center the spears with the width of the bale.

With the power unit, push the spear(s) into the large hay bale. Make sure you have penetrated the hay bale far enough so the bale doesn't want to come off the end of the spear(s). If, when you initially pick the bale up, it tends to droop forward, this would indicate you have not penetrated the bale far enough.

When building a stack of bales on the Rectangular Bale Handler, pick up the first bale and then drive to the second bale. Place the first bale on top of the second bale and then reverse the power unit to pull the spears out of the first bale. When clear of both bales, lower the Bale Handler until the spears are 10"-12" above the ground. Drive forward again and push the four tines into the bottom bale.

If handling "large (4' X 4' X 8') bales, two bales will be a full load. If handling "mid-size" rectangular bales, repeat the process for the third bale.

Tilt the ends of the spear(s) upward (about 15-20 degrees) when transporting the hay bales. This will reduce any tendency for the bale to slide off the spear(s) while being transported.

When you have placed the hay bale in the desired location, it is recommended to tilt the spears slightly downward (5-7 degrees) so as you pull away from the bale it will slide off the spear(s) more easily. Different location and circumstances will determine the best withdraw angle to use.

Raise the Bale Handler 16"-24" and drive to the truck to be loaded or location of the stack.

NOTE: Always make sure bale spear fully penetrates the bale. Partial penetration locates all the weight of the bale on the outer end and can damage spear.

NOTE: In cold weather, a bale frozen to the ground may exceed the lifting capacity of spear and loader. Damage to spear or loader may occur. Not covered under warranty.



ALWAYS OBEY ALL SAFETY RULES! ALWAYS BE CAREFUL!

OPERATING INSTRUCTIONS (continued)



WARNING!

Never allow anyone to ride on the Bale Handler or to stand or walk under it. The Bale Handler or bales could drop unexpectedly.

Always keep the Bale Handler as low as possible, and travel at a speed safe for conditions present, to prevent overturning the tractor or telehandler.

PLACING BALES

To place the bales in a stack or on a trailer, move the Bale Handler to the desired location.

When stacking bales, ALWAYS MAKE SURE BALES ARE PLACED SO THE STACK IS STABLE,

Keep all bystanders at a safe distance, REMEMBER - FALLING BALES CAN ROLL OR TUMBLE.

Bales may be stacked tight together by approaching the stack at a slight angle, then turning into already stacked bales to force the bales together. Use only minor force when doing this because excessive side-force may cause damage to the loader or Bale Handler.

There are several satisfactory methods for stacking bales with the Bale Handler. If a barn or shed is used, the stack may be built straight up. If the stack is outside, in high wind or rain areas, some taper may want to be used. Location and operator skill will determine the success of any method used. Stack height depends on the lifting height of the loader, and the density of the bales. Soft bales cannot be stacked as high as denser bales. A high-density bale is important for a solid stack; however soft-density bales may be used if the stack is built with more taper.

DO NOT USE the Bale Handler for any other purpose than moving bales.



CAUTION!

Beware of lift clearance when raising loader to maximum height.

When stacking or loading vehicles, make sure you are operating in an area AWAY FROM OVERHEAD WIRES.



DANGER!

Beware of low electrical wires when loader is raised. Serious injury or death can result if contact is made.

OPERATING PRECAUTIONS

Do not force the Bale Handler down on the bales. The weight of the Bale Handler and loader is sufficient.

Never rotate and lower the top of the Bale Handler first. Make slow and minor adjustments.

Never raise the front of the tractor or power unit by forcing the Bale Handler down. This causes extreme stress on the frame and brackets.

Keep the Bale Handler as low as practical at all times to reduce the possibility of tipping or contacting overhead wires or obstructions.

Braking efficiency will also be less if the center of gravity is raised.

Do not push or pull with the Bale Handler. Structural damage may result. Also, this may cause power unit to tip.

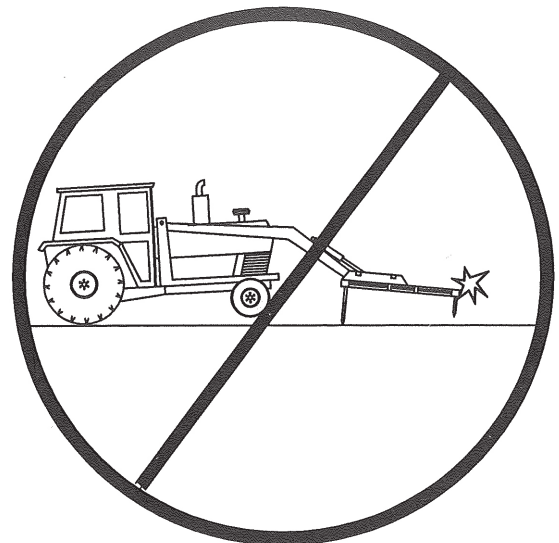

Do not force the Bale Handler down on the bales. The weight of the Bale Handler and loader is sufficient. Never rotate and lower the top of the Bale Handler first.

Never raise the front of the power unit by forcing the Bale Handler down. This causes extreme stress on the Bale Handler and brackets.

OPERATING INSTRUCTIONS (continued)

OPERATING PRECAUTIONS (cont.)



Keep the Bale Handler as low as practical at all times to reduce the possibility of tipping or contacting overhead obstructions. Braking efficiency will also be less if the center of gravity is raised.

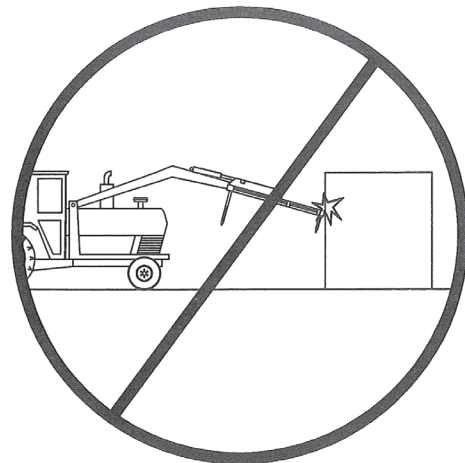

Do not push or pull with the Bale Handler. Structural damage may result. Also this may cause the power unit to tip.

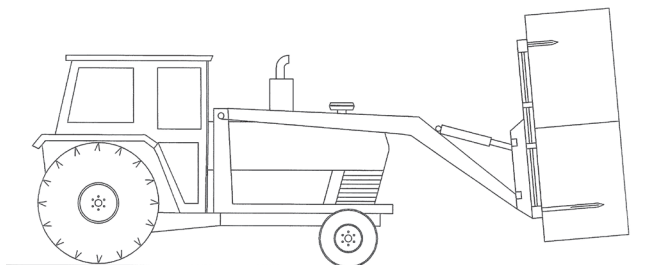

When transporting the bales, keep the Bale Handler low. Always travel at a safe and responsible speed. The increased weight on the front axle, and possible increased height, reduces the stability of the power unit and its braking efficiency.

TRANSPORTING



CAUTION!

When traveling on public roads, whether at night or during the day, use accessory light and devices for adequate warnings to operators of other vehicles. Comply with all federal, state, and local laws.

Do not travel on the road with bales on the Bale Handler. The power unit may tip if the brakes are applied quickly or if a rapid turn is made.

Check visibility. If visibility is impaired, reduce speed or consider other means of bale transport.

Allow for additional length of loader and attachment on power unit while turning.

Select a safe ground travel speed when transporting from one area to another. When traveling on roadways, transport in such a way that faster moving vehicles may pass you safely.

When traveling over rough or hilly terrain or when making turns, slow down and use extra care.

Read all the safety warnings in the front of this manual and in the manual of the power unit.

STORAGE

- At the end of the working season or when the Bale Handler will not be used for a long period, it is good practice to clean off any dirt or grease that may have accumulated.
- Inspect the Bale Handler for loose, damaged or worn parts and adjust or replace if needed.
- Sand areas where paint is chipped or worn and repaint to prevent rust.
- Always store in a safe place away from children or livestock.
- Storage location should be level and solid to make hitching and unhitching easy.
- Block equipment securely for storage.

OWNER SERVICE

MAINTENANCE

The information in this section is written for operators who possess basic mechanical skills. Should you need help, your dealer has trained service technicians available. For your protection, read and follow all safety information in this manual.



WARNING!

■ **NEVER GO UNDERNEATH EQUIPMENT.** Never place any part of the body underneath equipment or between moveable parts even when the engine has been turned off. Hydraulic system leak down, hydraulic system failures, mechanical failures, or movement of control levers can cause equipment to drop or rotate unexpectedly and cause severe injury or death.

- Service work does not require going underneath.
- Read Manual for service instructions or have service performed by a qualified dealer.



WARNING!

■ **Keep all persons away from operator control area while performing adjustments, service, or maintenance.**

■ **Before dismounting power unit or performing any service or maintenance, follow these steps:** disengage power to equipment, lower the 3 point hitch and all raised components to the ground, operate valve levers to release any hydraulic pressure, set parking brake, stop engine, remove key, and unfasten seat belt.



CAUTION!

■ **Always wear relatively tight and belted clothing to avoid entanglement in moving parts. Wear sturdy, rough-soled work shoes and protective equipment for eyes, hair, hands, hearing, and head.**

If the machine is used in heavy duty conditions, the maintenance operations must be carried out more frequently.

Thoroughly clean the grease zerks before servicing. Dirt mixed with lubricant will rapidly wear parts and destroy bearings. Keep it clean.

Check the pins at the ends of the loader arms. Make sure they are locked in place with the linchpins.

Periodically check all bolts to make sure they are tight.

Check hydraulic hoses. Make sure they are not chafed or pinched. Replace any damaged hose.

Check hydraulic hoses and fittings for leaks. Repair any leaks immediately. Never use your hand to check for a hydraulic leak when system is under pressure.

Replace any worn or damaged parts immediately. Do not use attachment with any damaged parts.

**REPLACE SAFETY SIGNS
IF DAMAGED OR MISSING.**

**OBEY ALL
SAFETY WARNINGS!**

TROUBLE-SHOOTING GUIDE

PROBLEM	POSSIBLE CAUSE	POSSIBLE REMEDY
Bale Handler is loose on loader.	1. Attachment not correct.	<p>U-bolts that connect quick-attach brackets to main frame may be loose or worn. Tighten or replace U-bolts.</p> <p>NOTE: If bolts are loose or damaged, it could be that they were never properly tightened. It also could be that the operator is impacting the Bale Handler into bales or ground during operation.</p> <p>Bale Handler mount may not be properly latched on power unit. Check lock pins.</p>
Bale Handler is off to one side of tractor and loader.	1. Lift brackets on frame not set correctly.	Loosen brackets and measure from center of frame to position correctly.
Bale shape is greatly distorted when handled.	1. Bale too soft.	Re-adjust baler to have firmer bale.
Tilt cylinders won't pull Bale Handler back after positioning horizontally.	1. Loader tilt cylinders are too close to loader arm pins in lift channels. 2. Loader too small for weight of bale being handled. 3. Hydraulic system not operating at correct pressure.	<p>Move further apart.</p> <p>Use larger tractor with larger size loader.</p> <p>Check pressure and adjust or repair.</p>
Excessive rear tractor tire slippage.	1. Tractor too small. 2. Insufficient traction.	<p>Use larger, heavier tractor.</p> <p>Add rear tire weights or add ballast in tire. Use tractor with FWDA.</p>
Bent or broken spears.	1. Improper operation. 2. Hitting foreign objects in bale. 3. Extremely hard, tight bales.	<p>Operator running spears into ground. Retrain operator.</p> <p>Check bales for tree limbs or other foreign objects.</p> <p>Bales are made with "green" material for silage bales - the Bale Handler may not be the proper attachment for this situation.</p>

NOTES

This image shows a single sheet of white paper with horizontal ruling lines. The lines are evenly spaced and run across the width of the page. There are no margins, text, or other markings on the paper.

RBH-4600 BALE HANDLER PARTS

NOTICE:

Effective 10/1/07 all loader attachments are supplied less mounting brackets. Pin-on / Quick-Attach brackets must be ordered separately.

**Note: RBH-4600U
Frame Shown**

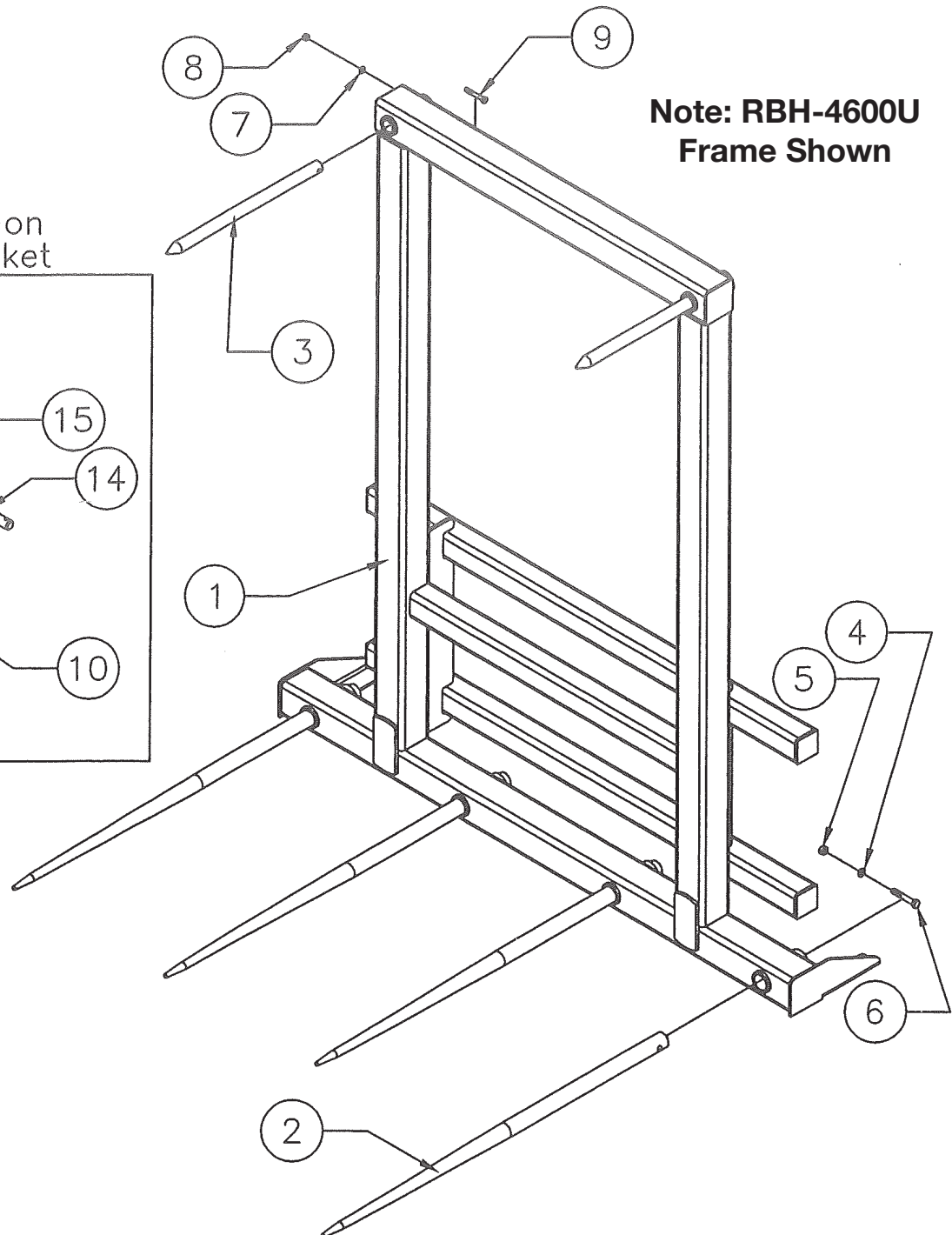
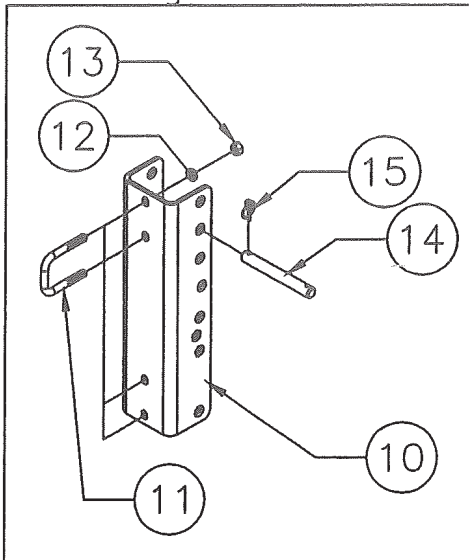

RBH-4600 BALE HANDLER

PARTS LIST

Ref. No.	Part No.	Description	No. Req'd.
1	833631	RBH-4600U Universal Frame Wldmt. (See other frames below)	-
2	830928	Spear, Bolt-In Forged (47.25")	4
3	830938	Spear, Bolt-In (21.00")	2
4	2502002	Washer 1/2" Springlock	4
5	2500003	Nut, Hex 1/2"-13NC	4
6	2503012	Bolt, Hex 1/2"-13NC x 3" Gr. 2	4
7	2502008	Washer 3/8" Springlock	2
8	2500004	Nut, Hex 3/8"-16NC	2
9	2503039	Bolt, Hex 3/8"-16NC x 2.50" Gr. 2	2
NS	101127	Safety Sign - Warning (Insert Spears)	1
NS	101560	Safety Sign - Warning	1
NS	833636	RBH-4610E Euro/Global Frame Wldmt.	-
NS	833641	RBH-4620M Manitou Frame Wldmt.	-
NS	833646	RBH-4630SS Skid Steer Frame Wldmt.	-
NS	833651	RBH-4640JCBQ JCB Q-Fit Frame Wldmt.	-
NS	833656	RBH-4650JDWL JD Wheel Loader Frame Wldmt.	-
NS	833661	RBH-4660GII JD Global II Frame Wldmt.	-
NS	833666	RBH-4670JRB-416 Frame Wldmt.	-
Optional Bolt-on Mounting Bracket			
10	830317	Lift Bracket Channel	2
11	830214	U-Bolt 5/8"-11NC x 3" ID x 4.50" Lg.	4
12	2502007	Washer 5/8" Springlock	8
13	2500013	Nut, Hex 5/8"-11NC	8
14	830309	Lift Pin 1"Ø x 8"	4
15	590034	AK-61 Linchpin 1/4"	8

RBH-6500 BALE HANDLER PARTS

NOTICE:

Effective 10/1/07 all loader attachments are supplied less mounting brackets. Pin-on / Quick-Attach brackets must be ordered separately.

**Note: RBH-6500U
Frame Shown**

Optional Bolt-on
Mounting Bracket

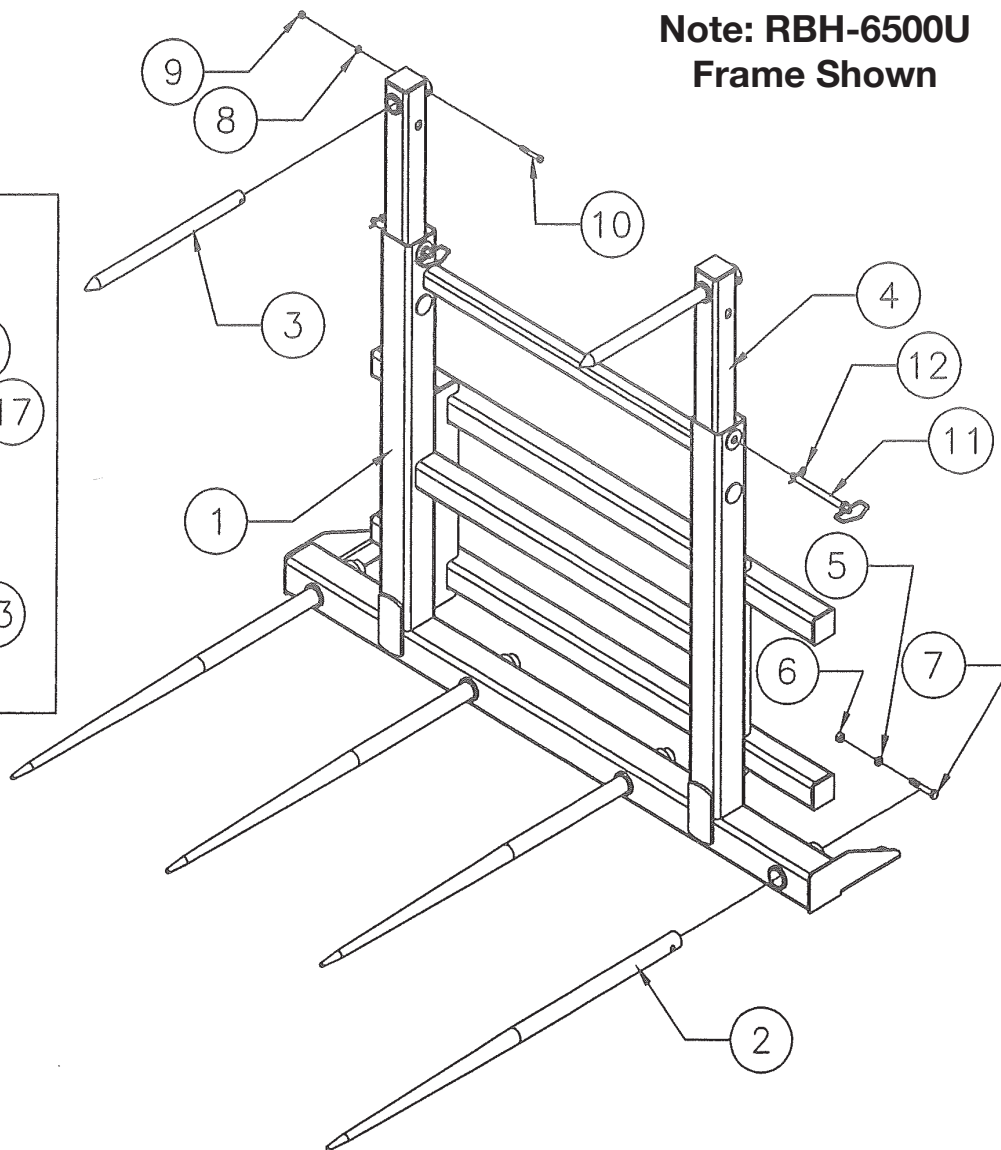
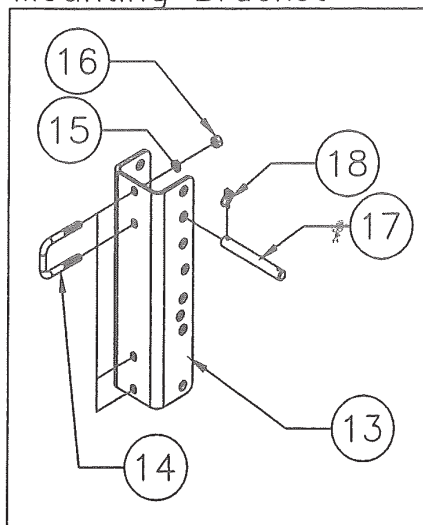

RBH-6500 BALE HANDLER

PARTS LIST

Ref. No.	Part No.	Description	No. Req'd.
1	833236	RBH-6500U Universal Frame Wldmt. (See other frames below)	-
2	830928	Spear, Bolt-In Forged (47.25")	4
3	830938	Spear, Bolt-In (21.00")	2
4	833130	Adjustable Backstop Sub-Weldment	2
5	2502002	Washer 1/2" Springlock	4
6	2500003	Nut, Hex 1/2"-13NC	4
7	2503012	Bolt, Hex 1/2"-13NC x 3" Gr. 2	4
8	2502008	Washer 3/8" Springlock	2
9	2500004	Nut, Hex 3/8"-16NC	2
10	2503039	Bolt, Hex 3/8"-16NC x 2.50" Gr. 2	2
11	2504288	Pin, Hitch 5/8" x 6-1/4"	2
12	590188	AK-2705 Hair Clip Pin	2
NS	101127	Safety Sign - Warning (Insert Spears)	1
NS	101560	Safety Sign - Warning	1
NS	101313	Safety Sign - Warning (Latches)	1
NS	833266	RBH-6510E Euro/Global Frame Wldmt.	-
NS	833271	RBH-6520M Manitou Frame Wldmt.	-
NS	833276	RBH-6530SS Skid Steer Frame Wldmt.	-
NS	833281	RBH-6540JCBQ JCB Q-Fit Frame Wldmt.	-
NS	833286	RBH-6550JDWL JD Wheel Loader Frame Wldmt.	-
NS	833211	RBH-6560GII JD Global II Frame Wldmt.	-
NS	833291	RBH-6570JRB-416 Frame Wldmt.	-
Optional Bolt-on Mounting Bracket			
13	830317	Lift Bracket Channel	2
14	830214	U-Bolt 5/8"-11NC x 3" ID x 4.50" Lg.	4
15	2502007	Washer 5/8" Springlock	8
16	2500013	Nut, Hex 5/8"-11NC	8
17	830309	Lift Pin 1"Ø x 8"	4
18	590034	AK-61 Linchpin 1/4"	8

APPLICATION INFORMATION

MAKE and MODEL APPLICATIONS FOR RECTANGULAR BALE HANDLERS IN RBH-4600 and RBH-6500 SERIES

- 1. RBH-4600U and RBH-6500U** These “universal” models can be fitted with a variety of bolt-on brackets for many makes and models of front end loaders and tractors. (Farm Type)

NOTE: Check the load capacity of the tractor and loader - - just because (check with dealer) the brackets are listed, does not mean that all loaders using them have the capacity required to handle the load safely.

- 2. RBH-4610E and RBH-6510E** Euro/Global connection on Farm Tractor Loaders on Tractors including, but not limited to:

AGCO 340

ALLIED ‘E’ SERIES

ALO-QUICKE Q700, Q720, Q730, Q740, Q750, Q760, Q900, Q935, Q945, Q955, Q965, Q975, Q985, Q1090

CASE IH L400, L405, L450, L500, L505, L550, L555, L600, L605, L650, L655, L700, L705, L750, L755, L800, L850, L855, LX156, LX162, LX720, LX730, LX740, LX760, LX770, LX780

CAT CHALLENGER ML72, ML75, ML77, ML94, ML96, ML97, ML98, ML99

FENDT LOADERS

JOHN DEERE 552, 553, 563, 673, H310, H340, H360, H380, (with Global Carrier)

KMW 1440, 1660, 1750, 1760, 1860

KUBOTA LA1954E, LA2254E

MASSEY-FERGUSON 950, 955, 960, 975, 985

McCORMICK L720, L750, L900, L1055, L1060, L1065, L1070

NEW HOLLAND 56LB, 62LB, 72LB, 810TL, 820TL, 830TL, 840TL, 850TL, 860TL, 870TL

ZETOR 90, 92, 92HL, 100, 101, 101SL, 102, 102HL, 102SLX, 112SLX, 202, 202SL, 202SLX, 302

- 3. RBH-4630SS and RBH-6530SS** Frames have the Skid Steer style coupler. Will fit most Skid Steer units and farm front loaders with the Skid Steer attaching means (and some Telehandlers).

NOTE: Make sure your Skid Steer unit or loader has a capacity rating for the bales you intend to handle.

COMPACT WHEEL LOADERS with SKID STEER TYPE COUPLERS including, but not limited to:

BOBCAT - A300, L65, 85, and L95

CASE - 21F, 121F, 221F, and 321F

CATERPILLER - 906H and 908H

GEHL - 140, 340, 540, AW536, AW546

JOHN DEERE - 240K, 244J, 304J, and 344J

KAWASAKI - 502V

KOMATSU - WA65-3, WA65PT-3

KUBOTA - R420S, R430, R520, R540, R640

MULTITRAC - RT30DT, XT1400, XT2400

NEW HOLLAND - W50T, W50TC, W80T, W80CHS, W60C, W70C

SWINGER - 1K, 2K, 2000AG, 3000

TAKEUCHI - TW40, TW65, TW65 Series 2, TW80, TW80 Series 2

TEREX - TL60, TL65, (and others with SS coupler)

VOLVO - L20B, L25B, L30B, L35B

WACKER NEUSON - WL-18, WL-25, WL-30, WL-50, 280, 850

APPLICATION INFORMATION (continued)

MAKE and MODEL APPLICATIONS FOR RECTANGULAR BALE HANDLERS IN RBH-4600 and RBH-6500 SERIES

4. **RBH-4620M and RBH-6520M** Frames have the Manitou quick attach coupler bracket welded to the frame. Coupler will connect to most Manitou Telehandlers. Some Gehl and New Holland Telehandlers also have the Manitou coupler. NOTE: Some compact models use the Skid Steer Attachment (ie-Gehl models GCT 3-14 & GCT 3-14+, Manitou models ULM 412 H, ULM 415H, MT420 and others.)
5. **RBH-4640JCBQ and RBH-6540JCBQ** Frames have a welded coupler for the JCBQ fit connection. Several JCB and some New Holland Telehandlers, also JCBTM 310 & TM 320 telescopic wheel loaders. JCB3CX-14, 3CX-15, 3CX-17, 4CX-14, 4CX-15, & 4CS-17 Backhoes.
6. **RBH-4660GII and RBH-6560GII** These frames are for large John Deere tractor loaders with the John Deere Global II connection. (John Deere loader models H480 & 700M).
7. **RBH-4670JRB-416 and RBH-6570JRB-416** Frames have welded coupler for the JRB-416 attaching design. This coupler will fit, including, but not limited to:

CASE 521D, 521E, 521F, 621D, 651E, 621F, 721F

CATERPILLAR 450F, 906M, 907M, 908M, 910K, 914K, 926M, 930M, 938M, 950M, 962M, IT14G2

DOOSAN DL200-5, DL200TC-5, DL250-5, DL250TC-5, ZW180PL-5B

HYUNDAI HL935, HL940, HI940TM, HL955

JCB 409, 411, 417, 427HT, 427ZX, 437ZX, 437HT

JOHN DEERE 710K, 324K, 344K, 444H, 444J, 444K, 524K, 544E, 544G, 544H, 544J, 544K, 624J, 624K, 710G, 710J, 710K, 710L

KAWASAKI 60Z7, 62Z7, 67Z7, 70Z7

KOMATSU WA150-6, WA200PZ-7, WA270PZ-8, WA320PZ-8

LIEBHERR L524, L528, L538, and L542

NEW HOLLAND LW90, LW110, LW130, W130, LW170, W170

TEREX TL160, TL210, TL260

VOLVO L45G, L50G, L60H, L70H, L

THIS PAGE LEFT INTENTIONALLY BLANK

THIS PAGE LEFT INTENTIONALLY BLANK



SAFETY REQUIREMENTS

AVOID ACCIDENTS BY FOLLOWING ALL OF THE SAFETY REQUIREMENTS LISTED BELOW.

- Machinery should be operated only by those who are responsible and are authorized to do so.
- Stop the engine, lower all equipment, lock the brakes, and remove the ignition key before dismounting from the tractor.
- Never stand between tractor and implement while tractor is being backed to hitch.
- Loose fitting clothing should not be worn, to avoid catching on various parts.
- Detach implement in area where children normally do not play.
- When performing adjustments or maintenance on an implement, first lower it to the ground or block it securely at a workable height.
- Only a qualified operator should be permitted on tractor when in operation; no riders allowed.
- Make certain everyone is in the clear before starting tractor or raising or lowering equipment.
- Operate the tractor and implement only while seating in the driver's seat.
- Reduce speed when transporting mounted implements to avoid bouncing and momentary loss of steering control.
- A heavy load can cause instability of the tractor. Use extreme care during road travel. Slow down on turns and watch out for bumps. Tractor may need counter-weights to counter-balance the weight of the implement.
- Reduce speed on hillsides or curves so there is no danger of tipping.
- Avoid driving too close to the edge of ditches or creeks.
- Do not transport implement on public roads without reflectors and slow moving vehicle emblem in daylight and with approved warning lights at night and other periods of poor visibility.
- Due to the width of some implements, use extra caution on highways, farm roads, and when approaching gates.
- Always be sure the implement is in the proper position for transport.
- Keep alert and watch the front as well as the rear when working with the implement.

**OWNER'S/
OPERATOR'S
MANUAL**

**MODELS IN
RBH-4600
and
RBH-6500
SERIES**

February 2025

RECTANGULAR BALE HANDLER

**WHEN ORDERING REPAIR PARTS,
ALWAYS GIVEN THE FOLLOWING INFORMATION:**

1. PART NUMBER
2. PART DESCRIPTION
3. MODEL NUMBER
4. NAME OF ITEM

**MAKE EVERY DAY
A HOLIDAY
FROM ACCIDENTS!**

WORKSAVER, INC.

P.O. BOX 100

LITCHFIELD, IL 62056-0100

(217) 324-5973

WEB: <http://www.worksaver.com>

EMAIL: sales@worksaver.com