

OWNER'S/ OPERATOR'S MANUAL

MODEL NO.'s

HK - 126, 132

226

326

426, 432

526

626, 632

726, 732

826

1026, 1032

1126, 1132

3026

CAUTION

For Safe Operation
Read Rules And
Instructions Carefully

SINO LEEINGLES, PIDA AYUDA
A AIGUIEN QUE SI LO LEA
PARA QUE LE TRADUZCA LAS
MEDIDAS DE SEGURIDAD.

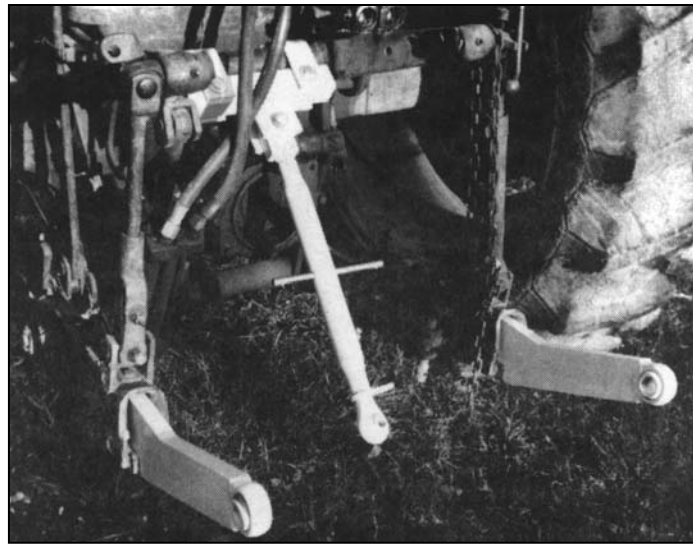

HK-126 mounted on IHC 560

2 PT. HITCH to 3 PT. HITCH ADAPTER KITS

For IHC/Farmall Tractors with "Fast Hitch"

Safety Instructions
Tractor Preparation
Operating Instructions

Assembly & Mounting
Maintenance
Repair Parts

CAUTION

**THE FOLLOWING SAFETY PRECAUTIONS SHOULD BE THOROUGHLY UNDERSTOOD
BEFORE ATTEMPTING TO BEGIN ASSEMBLING THIS MACHINE**

1. Select an area for assembly that is clean and free of any debris which might cause persons working on the assembly to trip.
2. Do not lift heavy parts or assemblies. Use crane, jack, tackle, fork trucks or other mechanical devices.
3. Preview the assembly instructions in your operator's manual before proceeding further.
4. If the assembly instructions call for parts or assemblies to be blocked up, use only blocking material that is in good condition and is capable of handling the weight of the assembly to be blocked. Also insure that the blocking material is on a clean, dry surface.
5. Never put hands, or any part of body, under blocked up assemblies if at all possible.
6. After completing assembly, thoroughly inspect the machine to be sure that all nuts, bolts, hydraulic fittings or any other fastened assemblies have been thoroughly tightened.
7. Before operating the machine, thoroughly read the operation section of your operator's manual.
8. Before operating, read the maintenance section of your operator's manual to be sure that any parts requiring lubrication, such as gearboxes, are full, to avoid any possible damage.
9. **Before operating equipment – If you have any questions regarding the proper assembly or operation, contact your dealer or representative.**

To the Owner/Operator/Dealer

All implements with moving parts are potentially hazardous. There is no substitute for a cautious, safe-minded operator who recognizes the potential hazards and follows reasonable safety practices. The manufacturer has designed this implement to be used with all its safety equipment properly attached to minimize the chance of accidents.

BEFORE YOU START!!

**Read the safety messages on the implement and shown in your manual.
Observe the rules of safety and common sense!**



THIS SYMBOL MEANS

- ATTENTION!**
- BECOME ALERT!**
- YOUR SAFETY IS INVOLVED!**

THIS SAFETY ALERT SYMBOL IDENTIFIES IMPORTANT SAFETY WARNING MESSAGES. CAREFULLY READ EACH WARNING MESSAGE THAT FOLLOWS. FAILURE TO UNDERSTAND AND OBEY A SAFETY WARNING, OR RECOGNIZE A SAFETY HAZARD, COULD RESULT IN AN INJURY OR DEATH TO YOU OR OTHERS AROUND YOU. THE OPERATOR IS ULTIMATELY RESPONSIBLE FOR THE SAFETY OF HIMSELF, AS WELL AS OTHERS, IN THE OPERATING AREA OF THE TRACTOR AND EQUIPMENT.

UNDERSTAND SIGNAL WORDS

Note the use of the signal words **DANGER**, **WARNING** and **CAUTION** with the safety messages. The appropriate signal word for each has been selected using the following guidelines:

DANGER: Indicates an imminently hazardous situation that, if not avoided, will result in death or serious injury. This signal word is to be limited to the most extreme situations typically for machine components which, for functional purposes, cannot be guarded.

WARNING: Indicates a potentially hazardous situation that, if not avoided, could result in death or serious injury, and includes hazards that are exposed when guards are removed. It may also be used to alert against unsafe practices.

CAUTION: Indicates a potentially hazardous situation that, if not avoided, may result in minor or moderate injury. It may also be used to alert against unsafe practices.

Important Safety Information!

Working with unfamiliar equipment can lead to careless injuries. Read this manual, and the manual for your tractor, before assembly or operating, to acquaint yourself with the machine. It is the equipment owner's responsibility, if this equipment is used by any person other than yourself, is loaned or rented, to make certain that the operator, prior to operating:

1. Reads and understands the operator's manuals.
2. Is instructed in safe and proper use.



The use of this equipment is subject to certain hazards which cannot be protected against by mechanical means or product design. All operators of this equipment must read and understand this entire manual, paying particular attention to safety and operating instructions, prior to using. If there is something in this manual you do not understand, ask your supervisor, or your dealer, to explain it to you.



Most accidents occur because of neglect or carelessness. Keep all helpers and bystanders twenty-five feet (25') from operating equipment. Only properly trained people should operate this tractor and attached implement. It is recommended the tractor be equipped with a Rollover Protection System (ROPS) and a seat belt that is used. Always stop the tractor, set brake, shut off the tractor engine, remove the tractor key, and lower implement to the ground before dismounting tractor. Never leave equipment unattended with the tractor running.

Safety Information



All equipment is potentially hazardous. There is no substitute for a cautious, safe-minded operator who recognizes potential hazards and follows reasonable safety practices.



When the use of hand tools is required to perform any part of assembly, installation, adjustment, maintaining, repairing, removal, or moving the implement, be sure the tools used are designed and recommended by the tool manufacturer for that specific task.



Personal protection equipment including safety glasses, safety shoes, and gloves are recommended during assembly, installation, operation, adjustment, maintaining, repairing, removal, or moving of the hitch kit.



Always use two people to handle heavy, unwieldy components during assembly, installation, removal, or moving of the hitch kit.



Never place any part of your body where it would be in danger if movement should occur during assembly, installation, operation, maintaining, repairing, removal, or moving the implement.



Never place yourself between the tractor and implement while implement is in operation.



Do not work under a raised implement unless it is securely blocked or held in position. Do not depend on the tractor hydraulic system to hold the implement in place.



A heavy load can cause instability of the tractor. Use extreme care during travel. Slow down on turns and watch out for bumps. The tractor may need front counter-weights to counter-balance the weight of the implement. An unstable tractor could steer badly and possibly tip over, causing injury or death.



Never use alcoholic beverages or drugs which can hinder alertness or coordination while operating equipment. Consult your doctor about operating tractor and implement while taking prescription medications.



Do not allow others to ride on the tractor with an operator. Riders are subject to injury such as being struck by foreign objects or being thrown off. Riders obstruct the operator's view resulting in unsafe operation. **Never allow anyone to ride on the implement!**



Before you operate any implement, check over all pins, bolts and connections to be sure all are securely in place. Replace any damaged or worn parts immediately.



Do not allow anyone who is not familiar with the safety rules and operation instructions to use this equipment.



Never allow children to operate or be around equipment.

















Do not exceed lift capacity of the tractor hitch.



Keep alert and watch the front as well as the rear when working with the attached implements.

Safety Information

-  When maneuvering close to buildings or passing through narrow areas, be sure to allow sufficient clearance for the implement.
-  Do not operate close to ditches or creeks. Slow down when operating over rough ground.
-  Always be sure the implement is in the fully raised position when in transport.
-  Pull from drawbar or lower 3 pt. arms only. Failure to hitch properly could cause tractor to flip over, resulting in serious injury or death.
-  Use extreme caution when backfilling deep holes or trenches.
-  Use care when working on slopes.
-  Avoid excessive speed during operation.
-  Make adjustments only when the implement is attached to the tractor.
-  When using a rear blade in a reverse position, use extra care. **Do not ram rear blade** into piles of dirt. Tractor lift arms and the rear blade are not built to take high impact loads in this position. **Ramming** backwards can also dislodge operator from seat and/or tractor controls, resulting in possible serious injury or death.
-  Always ease the tractor into the load. It may be necessary to reposition and take less “bite” on the material to move it safely.
-  Watch for and avoid hidden obstructions, i.e., buried pipes, rocks, concrete piers, uneven concrete slabs, stumps, etc., when operating rear blades, box scrapers, or other ground engaging implements.
-  NEVER operate any PTO driven implement unless tractor PTO guard is in place and PTO driveline shielding is in place.
-  Always shut off tractor and shift to “Park” or set brakes when leaving tractor. Always lower implement to ground. Remove key when leaving tractor unattended.
-  Before operating equipment: if you have any questions regarding the proper assembly or operation, contact your dealer or representative.

**ALWAYS OBEY ALL
SAFETY RULES!
ALWAYS BE CAREFUL!**

Safety is a primary concern in the design and manufacture of our products. Unfortunately, our efforts to provide safe equipment can be wiped out by a single careless act of an operator.

In addition to the design and configuration of equipment, hazard control and accident prevention are dependent upon the awareness, concern, prudence and proper training of personnel involved in the operation, transport, maintenance and storage of equipment.

It has been said, “The best safety device is an informed, careful operator.” We ask you to be that kind of an operator.

INSTRUCTIONS

The 2 pt. to 3 pt. adapter kits are designed for International Harvester/Farmall tractors that are equipped with the IHC "fast-hitch."

These kits allow 3 pt. equipment to be used on tractors that were for 2 pt. fast hitch equipment only.

NOTE: International Harvester Company (IHC) made the "fast-hitch" for a wide variety of tractors and in a few cases made variations on the hitch for the same model tractors.

TRACTOR PREPARATION

Be sure tires and rims are in good condition. Inflate tires to the proper recommended air pressure.

Check the tractor's hydraulic system. Refer to your tractor operator's manual or dealer for any adjustments necessary to put the hydraulic system in good working order. (I&T shop manuals will list most specifications and adjustment instructions – available from most farm equipment dealers.)

Check the shield over the PTO stub shaft. Make sure it is in good condition and bolted securely to the tractor. Purchase a new shield if old shield is damaged or missing. (You may have to use a tractor salvage yard for replacement parts on older tractors.)

It is recommended that a ROPS (Roll-Over Protection Structure) be installed on all tractors. Contact your local dealer for ROPS for your tractor.

Check the threaded holes that go into the rear tractor housing and make sure the threads are in good condition and that the holes are clean.

NOTE: The hole in the differential housing may have painted cork plugs in them. It is necessary to remove the cork and clean the holes.



CAUTION!

If an air hose is used to blow any loose rust or dirt from the holes, be sure safety glasses are used to prevent particles from entering an eye.



CAUTION!

Be sure your tractor is in good condition and properly equipped with counterweights. Read all the safety precautions and make sure all tractor operators are familiar with the safety rules of tractor operation.

ASSEMBLY

For instruction reference, the terms front or rear are based on the operator facing forward on the tractor, thus front is toward the front of the tractor and the rear is to the rear of the tractor.

It is suggested that all the instructions be read before beginning assembly.

Check the view of the topline bracket for your tractor model in this manual to see the relationship of the parts.

The prong assemblies slip into the prong sockets on your tractor. If you have ordered a kit for a 32" drawbar spacing (Category II), then there is a right-hand and a left-hand prong assembly.

The 2-way ball sockets on the end of the prongs will allow you to connect to either Category I or Category II implements. If the drawbar or implement you mount has Category I ($\frac{7}{8}$ " dia.) pins, then make sure the balls are turned so that the $\frac{7}{8}$ " dia. holes are used.

IMPORTANT: If the larger $1\frac{1}{8}$ " dia. holes are used with the smaller $\frac{7}{8}$ " dia. pins, the ball holes will wear rapidly in an uneven pattern and make the entire ball socket eventually unusable.

Fig. 2 for HK-126 & HK-132

Remove the top link clevises from the top link bracket. Place the top link clevises over the tractor's exposed rocker arm shaft and pivot them until they are parallel with the ground. Then slide the top link bracket assembly between the clevises and bolt back together. Attach the top link to the top link bracket.

NOTE: IHC/Farmall model 300 and 350 tractors were made with at least three different hitch configurations. Some have the exposed rockershaft, some have holes drilled and threaded in the rear differential, and the 300 rowcrop models require a special topline bracket (HK-3026). Check your tractor for which adapter kit is required.

NOTE: A few IHC model 460 and 560 tractors with an exposed rockershaft were made with a larger $2\frac{1}{8}$ " diameter rockershaft (normal rockershaft diameter is 2.0 inches). If you have one of these tractors with the larger $2\frac{1}{8}$ " shaft, contact Worksaver, Inc. and ask for a pair of 860129 clevis brackets that will accommodate the larger shaft diameter.

Fig. 3 for HK-226 & HK-326

Remove the belt pulley shaft cover, taking care not to damage the gasket. If the gasket is damaged, make a new one or use a good gasket sealing compound. Place the top link bracket against the gasket and housing of the tractor and secure it in place with the $\frac{7}{16}$ " - 14 x $4\frac{1}{2}$ " bolts and $\frac{7}{16}$ " lockwashers provided. Attach the top link to the top link bracket using the pin and linchpin provided.

INSTRUCTIONS (continued)

Fig. 4 for HK-426 & HK-432

Remove the bolt securing the PTO engagement lever. Place the top link bracket against the tractor housing and secure it in place with the $\frac{5}{8}$ " - 11 x $1\frac{3}{4}$ " bolts and $\frac{5}{8}$ " lockwashers. Bolt the PTO engagement lever to the small block on the top link bracket with the same bolt removed with it. Attach the top link to the top link bracket using the pin and linchpin provided.

Fig. 5, 6, 7, 8 & 9 for HK-526, HK-626, HK-632, HK-726, HK-732, HK-826, HK-1126 & HK-1132

Place the top link bracket against the tractor housing and bolt it in place with the bolts and lockwashers provided. Attach the top link to the top link bracket with the pin and linchpin provided.

Fig. 10 for HK-1026 & HK-1032

Place the top link bracket into position. Secure the R.H. end to the leveling screw hammer strap arm with the two (2) $\frac{5}{8}$ " x 2" carriage bolts. The L.H. end of the top link bracket bolts to the left side of the tractor differential housing with the two (2) $\frac{3}{4}$ " bolts. **NOTE:** Use care in routing the hose to the hydraulic lift cylinder. Be sure it doesn't chafe against the top link bracket. Wrapping a section of the hydraulic hose with a protective cover may be the best protection.

Fig. 11 for HK-3026

Place the top link bracket into position. Secure the R.H. end to the leveling screw hammer strap arm with the two (2) $\frac{5}{8}$ " x 2 $\frac{1}{2}$ " carriage bolts. The L.H. end of the top link bracket bolts to the left side of the tractor differential housing with the two (2) $\frac{3}{4}$ " bolts. **NOTE:** Use care in routing the hose to the hydraulic lift cylinder. Be sure it doesn't chafe against the top link bracket. Wrapping a section of the hydraulic hose with a protective cover may be the best protection. Attach the top link to the top link bracket with the pin and linchpin provided.

SAFETY TRAINING

- Know your controls and how to stop tractor, engine, and PTO quickly in an emergency. READ THIS MANUAL AND THE ONE PROVIDED WITH YOUR TRACTOR.
- To avoid accident or injury, do not allow anyone to operate this equipment without proper instructions. Any person who operates this equipment must be instructed in and be capable of the safe operation of the tractor, implement and all controls.
- Do not allow children to operate this machine.

! WARNING! !

MAKE SURE THAT ALL OPERATING AND SERVICE PERSONNEL KNOW THAT IN THE EVENT HYDRAULIC FLUID PENETRATES THE SKIN, IT MUST BE SURGICALLY REMOVED WITHIN A FEW HOURS BY A DOCTOR FAMILIAR WITH THIS FORM OF INJURY, OR GANGRENE MAY RESULT.

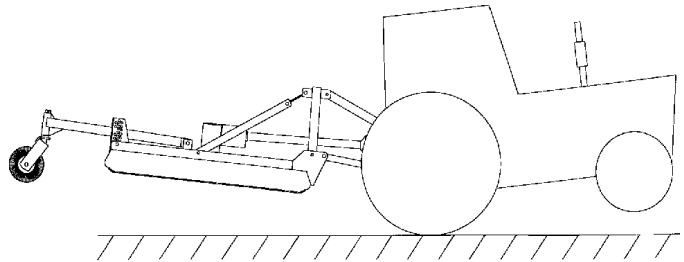

Tractor Stability

! WARNING! !

When using a 3 pt. hitch, a minimum 20% of tractor and equipment weight must be on tractor front wheels. Without this weight, tractor could tip up, causing possible loss of control and possible personal injury or death. The weight may be attained with a front end loader, front wheel weights, ballast in tires or front tractor weights. When attaining a minimum 20% of tractor and equipment weight on the front wheels, you must not exceed the ROPS weight certification. Weigh the tractor and equipment. DO NOT GUESS OR ESTIMATE!

! WARNING! !

A heavy load can cause instability in driving a tractor. Make sure the front of the tractor is properly counter-balanced with weights. Always drive slowly – especially around turns. An unstable tractor could steer badly and possibly tip over, causing injury or death.

INSTRUCTIONS (continued)

CAUTION!

When using a 3 pt. hitch rear blade in a reverse position (bulldozing), use extra care. **DO NOT RAM BLADE** into dirt or packed snow piles! Tractor lift arms and the blade are not built to take high impact loads in this position. **RAMMING** backwards can also dislodge operator from seat and/or tractor controls, resulting in possible serious injury or death.

Always ease the tractor into the load. It may be necessary to reposition and take less “bite” on the material to move it safely.

Watch for and avoid hidden obstructions, i.e., buried pipes, rocks, concrete piers, uneven concrete slabs, stumps, etc., when operating. This is especially of concern when removing snow.

OPERATION

Make sure all operators have read all the safety warnings and precautions in this manual and those in the tractor operator's manual.

Be sure tractor is properly counterbalanced with weights before attempting to lift any load or implement.

Since the tractor prong sockets and prongs can only be moved apart an inch or two, you may have to use the following procedure to connect to the implement. Back the tractor to within 3-5 inches of the implement. Then get off the tractor and unlock the prong latch and partially pull the prong assembly from the prong socket. This should allow you enough movement to slide the ball on the end of the prongs on to the implement pull pins. Then slowly back the tractor to reconnect the prong arms into the prong sockets.

On a few pieces of equipment, it may be necessary to attach the prongs to the implement first and then connect to the tractor.

You may want to consider adding a 3 pt. Quick Hitch to your tractor to make connecting and unhooking implements easier. A Quick Hitch will allow you to connect or unhook most implements from the tractor seat.

These kits are designed to lift up to 2000 lbs., but, of course, lifting capacity is dependent on the size of the tractor and on the pressure and condition of the tractor's hydraulic system. You will also find that the closer the load is kept to the tractor, the more you will be able to lift.

WARNING!

- ▲ Keep clear of rotating parts; stay on tractor seat until all motion has stopped.
- ▲ Be sure tractor engine is off and key is removed before making any adjustments.
- ▲ Do not get under machine to make measurements or adjustments without securely blocking implement first.
- ▲ Always wear relatively tight and belted clothing to avoid entanglement in moving parts. Wear sturdy, rough-soled work shoes and protective equipment for eyes, hands, and hearing. Never operate tractor in bare feet, sandals, or sneakers.
- ▲ Operate only in daylight or good artificial light.
- ▲ Ensure implement is properly mounted, adjusted and in good operating condition.
- ▲ Ensure that all safety shielding and safety signs are properly installed and in good condition.

MAINTENANCE

Inspect the hitch kit for loose, damaged or worn parts and adjust or replace if needed.

Repaint parts where paint is worn or scratched to prevent rust.

Check all bolts and nuts to be sure they are tight.

Periodically oil the following:

- a. Top link (upper 3rd link) threads
- b. Ball sockets
- c. Leveling assembly threads

REPLACE SAFETY SIGNS IF DAMAGED OR MISSING!

When completing a maintenance or service function, make sure all safety shields and devices are installed before placing unit in service.

SAFETY SIGN

WARNING

Pull from drawbar or 3-Pt. lower lift arms only. Failure to hitch properly could cause tractor flip-over, resulting in serious injury or death.

101082

Model Number	Factory Number	Application
HK-126 HK-132	864126 864132	Cat. I For IHC/FARMALL 300, 330, 340, 350, 450, 460, 560 Cat. II and other models having exposed round rockershaft (Not for 460 or 560 utility models. See below.) (Not for 300 row crop models or most 300 utility models.)
HK-226	864226	Cat. I For IHC/FARMALL 240. (Top link bracket replaces casting at top rear of tractor or belt pulley housing.) 3" prong.
HK-326	864326	Cat. I For IHC/FARMALL C, Super C, 200, 230 (2½" prongs)
HK-426 HK-432	864426 864432	Cat. I For IHC/FARMALL 544 and 656 Cat. II
HK-526	864526	Cat. I For IHC/FARMALL 240 (For models with 3 holes on rear housing of mount 5 x 5.5 flat plate top link bracket.) 3" prongs.
HK-626 HK-632	864626 864632	Cat. I For IHC/FARMALL 706, 756, 806, 826, 856, 1206 and other models Cat. II
HK-726 HK-732	864726 864732	Cat. I For IHC/FARMALL 606 Cat. II
HK-826	864826	Cat. I For IHC/FARMALL 404, 504, and some 300, 350 models. For all 300, 330, 340, 350 and 574 Utility models. (Rockershaft not exposed or not round.) (3 threaded holes on rear housing.)
HK-3026	864336	Cat. I For FARMALL 300 Row Crop (With no exposed rockershaft)
HK-1026 HK-1032	864134 864135	Cat. I For FARMALL 400 Row Crop (With no exposed rockershaft) Cat. II
HK-1126 HK-1132	864127 864128	Cat. I For IHC 460 and 560 Utility Models Cat. II

NOTE: Cat. I = 26" Spacing
Cat. II = 32" Spacing

**OBEY ALL
SAFETY WARNINGS!**

2 PT. HITCH ADAPTER KIT REPAIR PARTS LIST

REF. NO.	PART NO.	DESCRIPTION	NO. REQ'D.
PARTS COMMON TO ALL KITS (EXCEPT HK-326) - FIG. 1			
1	860123	3" Hitch Prong (Cat. I & II, 26" Spacing)	2
NS	860124	3" Hitch Prong (Cat. I & II, 32" Spacing) Left-Hand	1
NS	860125	3" Hitch Prong (Cat. I & II, 32" Spacing) Right-Hand	1
NS	590006	$\frac{7}{16}$ " Spring Ring Linchpin (AK-14)	1
NS	101082	Decal - Safety Warning	1
PARTS FOR HK-126 & HK-132 - FIG. 2			
4	861420	Complete Cat. I Top Link (HK-126 only)	1
4	860130	Complete Cat. II Top Link (HK-132 only)	1
5	861421	Top Link Repair End, Left-Hand	1
6	860117	Top Link Bracket	1
7	860106	Top Link Clevis	2
8	2503109	$\frac{1}{2}$ " - 13 NC x $3\frac{1}{2}$ " Hex Head Bolt	2
9	2502002	$\frac{1}{2}$ " Spring Lock Washer	2
10	2500003	$\frac{1}{2}$ " - 13 NC Full Hex Nut	2
12	590002	Top Link Pin, Cat. I (AK-9)	1
NS	590027	Top Link Bushing (Cat. I to II) (AK-54) (HK-132 only)	1

FIG. 1

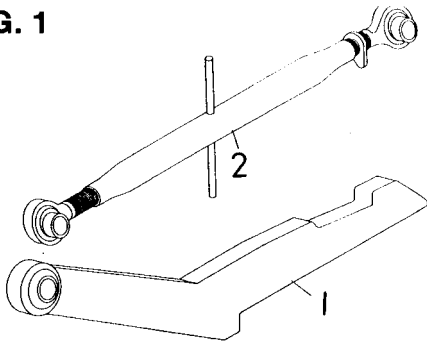
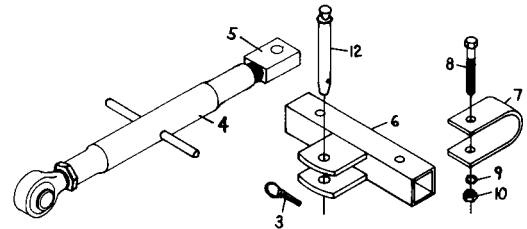
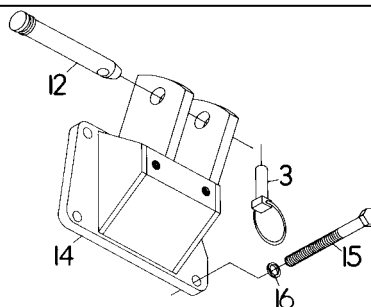

FIG. 2



PARTS FOR HK-226 - FIG. 3			
2	590072	Complete Cat. I Top Link - See Fig. 1	1
12	590002	Top Link Pin, Cat. I (AK-9)	1
14	860304	Top Link Bracket Assembly	1
15	2503052	$\frac{7}{16}$ " - 14 NC x $4\frac{1}{2}$ " Hex Head Bolt	4
16	2502006	$\frac{7}{16}$ " Spring Lock Washer	4
PARTS FOR HK-326 - FIG. 3			
3	590006	Spring Ring Linchpin (AK-14)	1
12	590002	Top Link Pin, Cat. I (AK-9)	1
14	860304	Top Link Bracket Assembly	1
15	2503052	$\frac{7}{16}$ " - 14NC x $4\frac{1}{2}$ " Hex Head	4
16	2502006	$\frac{7}{16}$ " Spring Lock Washer	4
2	590072	Complete Cat. I Top Link - See Fig. 1	1
NS	860118	$2\frac{1}{2}$ " Hitch Prong (Cat. I & II, 26" Spacing)	

FIG. 3



Continued on pages 9 & 10

REF. NO.	PART NO.	DESCRIPTION	NO. REQ'D.
PARTS FOR HK-426 & HK-432 - FIG. 4			
17	860401	Top Link Bracket Assembly	1
18	2503106	$\frac{5}{8}$ " - 11NC x $1\frac{3}{4}$ " Hex Head Bolt	4
19	2502007	$\frac{5}{8}$ " Spring Lock Washer	4
2	590076	Cat. II Top Link Assembly (AK-600) See Fig. 1	1
NS	590027	Top Link Bushing (Cat. I to II) (AK-54)	1
21	590028	Cat. II Top Link Pin (AK-56A)	1
PARTS FOR HK-526 - FIG. 5			
12	590002	Top Link Pin, Cat. I (AK-9)	1
22	860501	Top Link Bracket Assembly	1
23	2503026	$\frac{1}{2}$ " - 13NC x $1\frac{1}{4}$ " Hex Head Bolt	3
24	2502002	$\frac{1}{2}$ " Spring Lock Washer	3
2	590072	Complete Cat. I Top Link - See Fig. 1	1

FIG. 4

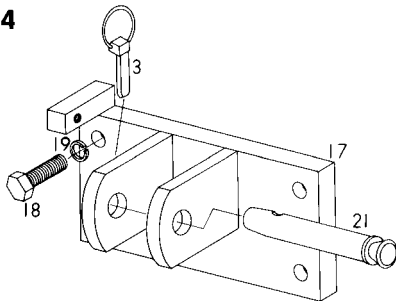
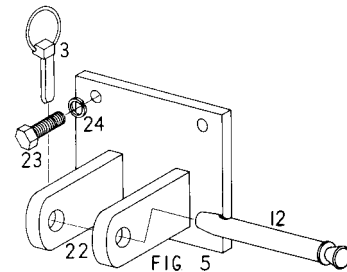

FIG. 5



PARTS FOR HK-626 & HK-632 - FIG. 6			
19	2502007	$\frac{5}{8}$ " Spring Lock Washer	4
2	590076	Complete Cat. II Top Link Assembly (AK-600) See Fig. 1	1
21	590028	Top Link Pin, Cat. II (AK-56A)	1
25	860601	Top Link Bracket Assembly	1
26	2503048	$\frac{5}{8}$ " - 11NC x 2" Hex Head Bolt	4
NS	590027	Top Link Bushing, Cat. I to II (AK-54)	1
PARTS FOR HK-726 & HK-732 - FIG. 7			
19	2502007	$\frac{5}{8}$ " Spring Lock Washer	3
2	590076	Complete Cat. II Top Link Assembly (AK-600) See Fig. 1	1
21	590028	Top Link Pin, Cat. II (AK-56A)	1
26	2503048	$\frac{5}{8}$ " - 11NC x 2" Hex Head Bolt	3
27	860701	Top Link Bracket Assembly	1
NS	590027	Top Link Bushing, Cat. I to II (AK-54)	1
PARTS FOR HK-826 - FIG. 8			
12	590002	Top Link Pin, Cat. I (AK-9)	1
19	2502007	$\frac{5}{8}$ " Spring Lock Washer	3
28	860801	Top Link Bracket Assembly	1
29	2503047	$\frac{5}{8}$ " - 11NC x $1\frac{1}{2}$ " Hex Head Bolt	3
2	590072	Complete Cat. I Top Link - See Fig. 1	1

FIG. 6

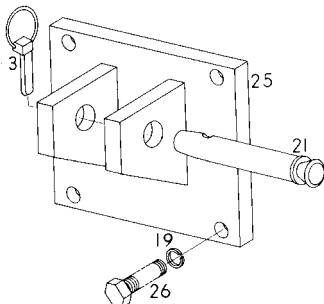

FIG. 7

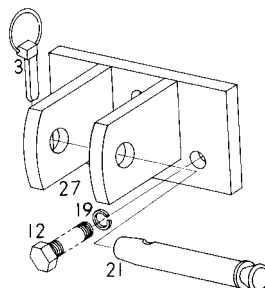
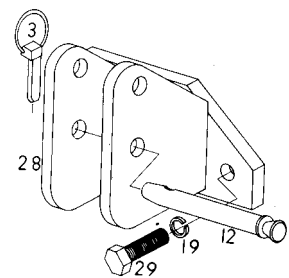

FIG. 8



REF. NO.	PART NO.	DESCRIPTION	NO. REQ'D.
PARTS FOR HK-1126 & HK-1132 - FIG. 9			
12	590002	Top Link Pin, Cat. I (AK-9)	1
18	2503106	$\frac{5}{8}$ " - 11NC x $1\frac{3}{4}$ " Hex Head Bolt	3
19	2502007	$\frac{5}{8}$ " Spring Lock Washer	3
2	590076	Complete Cat. II Top Link Assembly (AK-600) (HK-1132 Only) See Fig. 1	1
30	860113	Top Link Bracket Assembly	1
2	590072	Complete Cat. I Top Link (HK-1126 Only) See Fig. 1	1
NS	590027	Top Link Bushing, Cat. I to II (AK-54) (HK-1132 Only)	2
PARTS FOR HK-1026 & HK-1032 - FIG. 10			
31	864137	Top Link Bracket Weldment	1
2	590072	Top Link, Cat. I Complete - See Fig. 1	1
12	590002	Top Link Pin, Cat. I (AK-9)	1
32	2503195	Bolt, $\frac{5}{8}$ " - 11NC x $2\frac{1}{2}$ " Carriage Head	2
19	2502007	Washer, $\frac{5}{8}$ " Spring Lock	2
33	2500013	Nut, $\frac{5}{8}$ " - 11NC Full Hex	2
34	2503002	Bolt, $\frac{3}{4}$ " - 10NC x 2" Hex Head	1
35	2502001	Washer, $\frac{3}{4}$ " Spring Lock	2
36	2503021	Bolt, $\frac{3}{4}$ " - 10NC x $2\frac{1}{2}$ " Hex Head	1

FIG. 9

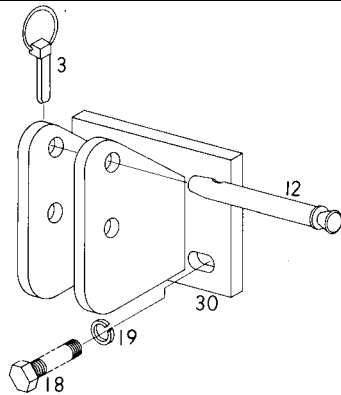
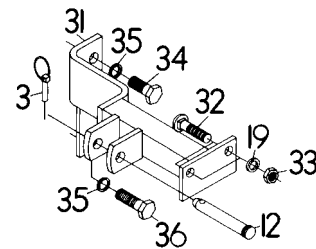
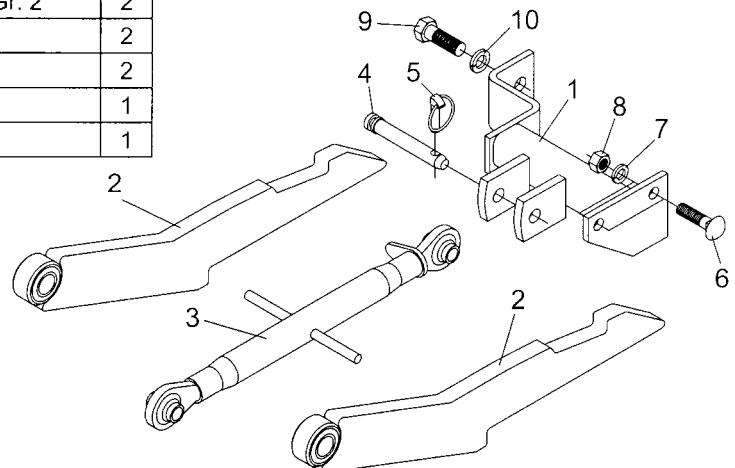

FIG. 10



Ref. No.	Part No.	Description	No. Req'd.
1	864337	Top Link Bracket Weldment	1
2	860123	Prong Weldment	2
3	590072	Top Link, Cat. I (AK-500F)	1
4	590002	Top Link Pin Cat. I (AK-9)	1
5	590006	Linch Pin 7/16" (AK-14)	1
6	2503195	Bolt 5/8"-11NC x 2 1/2" Carriage Head Gr. 2	2
7	2502007	Washer 5/8" Springlock	2
8	2500013	Nut 5/8"-11NC Full Hex	2
9	2503002	Bolt 3/4"-10NC x 2" Hex Head Gr. 2	1
10	2502001	Washer 3/4" Springlock	1

HK-3026 CONVERSION KIT PARTS LIST



⚠ SAFETY PRECAUTIONS ⚠

**MOST ACCIDENTS OCCUR BECAUSE OF NEGLIGENCE OR CARELESSNESS.
AVOID NEEDLESS ACCIDENTS BY FOLLOWING ALL OF THE SAFETY PRECAUTIONS LISTED BELOW.**

- Machinery should be operated only by those who are responsible and are authorized to do so.
- Stop the engine, lower all equipment, lock the brakes, and remove the ignition key before dismounting from the tractor.
- Never stand between tractor and implement while tractor is being backed to hitch.
- Loose fitting clothing should not be worn, to avoid catching on various parts.
- Detach implement in area where children normally do not play.
- When performing adjustments or maintenance on an implement, first lower it to the ground or block it securely at a workable height.
- Only a qualified operator should be permitted on tractor when in operation; no riders allowed.
- Make certain everyone is in the clear before starting tractor or raising or lowering equipment.
- Operate the tractor and implement only while seated in the driver's seat.
- Reduce speed when transporting mounted implements to avoid bouncing and momentary loss of steering control.
- A heavy load can cause instability of the tractor. Use extreme care during road travel. Slow down on turns and watch out for bumps. Tractor may need front counterweights to counter-balance the weight of the implement.
- Reduce speed on hillsides or curves so there is no danger of tipping.
- Avoid driving too close to the edge of ditches or creeks.
- Do not transport implement on public roads without reflectors and slow moving vehicle emblem in daylight and with approved warning lights at night and other periods of poor visibility.
- Due to the width of some implements, use extra caution on highways, farm roads, and when approaching gates.
- Always be sure the implement is in the proper position for transport.
- Keep alert and watch the front as well as the rear when working with the implement.

OWNER'S/ OPERATOR'S MANUAL

**WHEN ORDERING
REPAIR PARTS, ALWAYS
GIVE THE FOLLOWING
INFORMATION:**

1. PART NUMBER
2. PART DESCRIPTION
3. MODEL NUMBER
4. NAME OF ITEM

APRIL 2007

STATEMENT OF POLICY

It is the policy of Worksaver, Inc. to improve its products where it is possible and practical to do so. Worksaver, Inc. reserves the right to make changes or improvements in design and construction at any time, without incurring the obligation to make these changes on previously manufactured units.

2 PT. HITCH to 3 PT. HITCH ADAPTER KITS

For IHC/Farmall Tractors with "Fast Hitch"

WORKSAVER LIMITED WARRANTY

Worksaver warrants its implements, parts and accessories to be free from defects in materials and workmanship for a period of six (6) months from date of purchase. Upon written approval, Worksaver will repair or exchange without charge any part, which upon examination by Worksaver or its authorized agent, shall disclose to be defective.

This does not apply to (1) parts that have worn out in normal use, (2) parts broken because of improper assembly or operation by the customer, (3) parts accidentally damaged, (4) failure of parts traceable to improper care, (5) parts failing through use of implement for purposes other than those for which it was designed.

The obligations assumed by Worksaver and the limitations expressed herein are in lieu of all other warranties expressed or implied.

WORKSAVER, INC.

P.O. BOX 100 LITCHFIELD, IL 62056-0100 (217) 324-5973
WEB: <http://www.worksaver.com> E-MAIL: sales@worksaver.com